

NOTICE!!

These documents have been scanned!

Do not place un-scanned documents beneath this notice!

Do not remove this notice from this file!

GPO Jacket No. 560-102
Print Order 61540
Rise Business Services, LLC
Job=AZ15 6/26/2019



Box Number= AZ15131



Claim Begin-End: AMC364399-AMC364399

1 Initial Receipt



AZ15131-12

AMC364221-AMC364399

**United States Department of the Interior
Bureau of Land Management**

BUSINESS & SUPPORT SVCS DIV
222 N CENTRAL AVE
PHOENIX, AZ 85004 -2203
Phone: (602) 417-9200

Receipt	
No:	1027897

Transaction #: 1064192
Date of Transaction: 02/16/2005

CUSTOMER: JOSEPH GRIEGER
7222 E JASMINE ST
MESA, AZ 85207

ENTERED IN COMPUTER
82 3/3/05

LINE #	QTY	DESCRIPTION	REMARKS	UNIT PRICE	TOTAL
1	1.00	LOCATABLE MINERALS / MINING CLAIMS-NEW, UNADJUDI, ONE OR MORE AUTH NO'S / NEW MINING CLAIM LOCATION FEE \$25 (1993) CASES: AMC364399/\$25.00		- n/a -	25.00
2	1.00	LOCATABLE MINERALS / MINING CLAIMS-NEW, UNADJUDI, ONE OR MORE AUTH NO'S / NEW MINING CLAIM SVC CHG \$10 (1930) CASES: AMC364399/\$10.00		- n/a -	10.00
3	1.00	LOCATABLE MINERALS / MINING CLAIMS-NEW, UNADJUDI, ONE OR MORE AUTH NO'S / NEW MINING CLM MAINT FEE \$100(1993) CASES: AMC364399/\$100.00		- n/a -	100.00
TOTAL:					\$135.00

PAYMENT INFORMATION			
NOTE: Items will appear on credit card statement as "Bureau of Land Management".			
1	AMOUNT:	\$135.00	POSTMARKED: N/A
	TYPE:	CREDIT CARD	RECEIVED: 02/16/2005
	NAME:	GRIEGER, JOSEPH 7222 E JASMINE ST MESA AZ 85207	
	CARD NO:	XXXXXXXXXXXX1009	AUTH CODE: 167672
	NAME ON CARD:	GRIEGER/JOSEPH R	
	EXPIRES:	07/31/2006	
	SIGNATURE:		

REMARKS

This receipt was generated by the automated BLM Collections and Billing System and is a paper representation of a portion of the official electronic record contained therein.

NOTICE!!

These documents have been scanned!

Do not place un-scanned documents beneath this notice!

Do not remove this notice from this file!

GPO Jacket No. 560-102
Print Order 61540
Rise Business Services, LLC
Job=AZ15 6/26/2019



Box Number= AZ15131



Claim Begin-End: AMC364399-AMC364399

2 Correspondence



AZ15131-12

AMC364221-AMC364399



United States Department of the Interior



BUREAU OF LAND MANAGEMENT

Arizona State Office

One North Central Avenue, Suite 800

Phoenix, Arizona 85004-4427

www.blm.gov/az/

November 2, 2012

In Reply Refer To:

3800 (9310) AT

AMC362401, AMC362442, AMC362705, **AMC364399**

CERTIFIED MAIL – RETURN RECEIPT REQUEST 7012 2210 0000 8675 2346

NOTICE

WARE DAN, ET AL
PO BOX 1200
APACHE JUNCTION, AZ 85117

This Notice Affects Those Claims
Shown in the Block Below.

AMC362401, 362442, 362444, 362445, 362705, 364399
M & M, B & B, RIO SECO, SOARING EAGLE 2, DESERT ROSE 1, STANTON ROCKER 1

2013 Maintenance Fees - Additional Fees Required

Your maintenance fee payment for the 2013 assessment year, in the amount of \$140 per claim, for the placer claims listed above, has been received and is insufficient. **The total due on your claim(s) is: \$3,500.**

In accordance with the Consolidated Appropriations Act of 2012, Public Law 112-74 (125 Stat 1047), and FR44155-44158 (2012) Congress changed the way maintenance fees for placer mining claims are assessed. Instead of charging the maintenance fee on a per-claim basis, Congress stated that the fee, which is currently \$140, will be assessed on each 20 acre parcel of a placer claim or portion thereof.

Insufficient payment of the annual maintenance fee for the 2013 assessment year is a curable defect. **Therefore you are required to do one of the following within 30 days of receipt of this notice or your claim(s) will be declared forfeited:** 1) submit additional fees of \$140 per 20-acres or portion thereof based on the full acreage of the claim, or 2) amend the claim(s) to reduce the acres so a lesser fee is due and submit any additional fees due; or 3) relinquish the claim(s) in their entirety, in which case BLM will refund the maintenance fees you have already paid for the 2013 assessment year.

If you choose to amend the claims to reduce the acres, you must submit an amended location notice for each claim, with an accurate description and dimensions of the reduced claim, along with a map depicting the reduced claim, and a \$10 processing fee per amendment. An amendment must also be recorded at the county. If the amended claim contains more than 20 acres, calculate the additional fees due and submit those fees with the amendment(s).

pd addl \$140 owed
on AMC 364399

1/8/12 AT

NO. OF CLAIMS

AMOUNT

RECEIPT NO.

INIT.

** BLM-ASO**

RECEIVED
BLM PHOENIX OFFICE
2012 NOV 23 P 2:48
PHOENIX, ARIZONA

\$140.00
2695221
A.H.

UNITED STATES
DEPARTMENT OF THE INTERIOR
BUREAU OF LAND MANAGEMENT
**MAINTENANCE FEE PAYMENT FORM
FOR PLACER MINING CLAIMS**

Remitter Name: Dan Ware
 Mailing Address: P.O. Box 1200
 City, State, Zip: Apache Jct. Az. 85117

Check here if this is a change of address.

FOR COUNTY RECORDER'S USE

*See attached papers please, we are
 paying remainder to retain claim,
 Thank you! Dan & Ware*

No. of claims 1 of 40 acres
 Total due BLM \$ 140.00

- The maintenance fee may be paid by cash, check, money order, Bureau of Land Management (BLM) Declining Deposit Account, or credit card (VISA, American Express, Discover, or MasterCard). Payments must be remitted to the BLM State Office where your claim or site is recorded and received on or before September 1. If the payment is mailed, the envelope must be postmarked by a bona fide delivery service on or before September 1 and received at the proper BLM State Office within 15 calendar days after the due date. Payments may also be made by telephone using a credit card. A complete listing of BLM State Offices with their addresses and phone numbers can be found at <http://www.blm.gov>.
- The maintenance fee for the following claim(s) applies to the assessment year _____.

CLAIM NAME	BLM SERIAL NO.	ACRES IN CLAIM	PAYMENT DUE TO THE BLM (See Instructions on Page 2)
Stanton Rocker 1	364399	40 total	Balance due of
		CK# 1406	\$ 140.00
8-28-12	CK# 1396	Previous Pd	\$ 140.00

RECEIVED
 NOV 23 P 2:48
 2012

Use a separate sheet for additional claim names, serial numbers, and claimant names and addresses.

RECEIVED
BLM AZ STATE OFFICE
2012 AUG 29 P 3:00
PHOENIX, ARIZONA

RECEIVED
BLM AZ STATE OFFICE
2011 AUG 22 A 7:50
PHOENIX, ARIZONA
BLM
Date
Stamp

MAINTENANCE FEE PAYMENT

Claimant Name: Dan Ware
 Address: P.O. Box 1200
 City: Apache Jet. State: Az Zip: 85217
 Telephone: 480-720-7486
 E-mail address: _____
 Signature: Dan Ware

Check here if this is a change of address.

LINE NO.	AMC NUMBER	CLAIM/SITE NAME	COUNTY RECORDER DATA (If available)	TWP	RNG	SEC
1	362705	Desert Rose 1	2006-0510015	2S	6W	19/20
2	362445	Soaring Eagle 2		12N	2W	12/13
3	362401	Midget		9N	10E	5/6-7
4	362442	B+B	2003-015410	9N	10E	7/8-18
5	362444	Rio Seco	2006-058036	2S	15E	5/8-9
6	364399	Stanton Rocker 1	2005-3835835	9N	4W	18
7						
8						
9						
10						

List additional claims on Form MCF114.

Bureau of Land Management
 Arizona State Office
 www.blm.gov/az/

No. of Claims: 6 x \$140 = \$840.00
 Check No: 1358 Init. SW
 Receipt No.: 2410807
 For BLM Use Only

Form: MCF112
 Revised July 2009

This form is available from the Arizona Department of Mines and Mineral Resources and may be reproduced.

NO. OF CLAIMS 6
 AMOUNT \$840.00
 RECEIPT NO. 2644837
 INIT. D.W.

United States Department of the Interior
Bureau of Land Management
 LANDS/RECREATION & PLANNING
 ONE N CENTRAL AVE
 PHOENIX, AZ 85004 -2203
 Phone: 602-417-9200

Receipt

No: 2644837

Transaction #: 2725598	
Date of Transaction: 08/30/2012	
CUSTOMER:	
DAN WARE PO BOX 1200 APACHE JUNCTION, AZ 85117-4048 US	

LINE #	QTY	DESCRIPTION	REMARKS	UNIT PRICE	TOTAL
1	1.00	LOCATABLE MINERALS / MINING CLAIMS-NOT NEW-UNADJUD, ONE AUTH NO. ONLY / MINING CLAIM MONEY RECEIVED CASES: AMC362705/\$840.00	MAINT FEE PYMNT (6) 2013	- n/a -	840.00
TOTAL:					\$840.00

PAYMENT INFORMATION			
1	AMOUNT:	840.00	POSTMARKED: N/A
	TYPE:	CHECK	RECEIVED: 08/29/2012
	CHECK NO:	1395	
	NAME:	SUPERSTITION MOUNTAIN TREASURE HUNTERS INC 940 W APACHE TRAIL APACHE JUNCTION AZ 85120 US	

REMARKS

This receipt was generated by the automated BLM Collections and Billing System and is a paper representation of a portion of the official electronic record contained therein.

RECEIVED
 2012 NOV 23 10:24 AM
 PHOENIX / BLM



P.O. Box 1200
Sage Junction, AZ 85217

RECEIVED
BLM AZ STATE OFFICE

2012 NOV 23 P 2:26

PHOENIX, ARIZONA

PHOENIX AZ 852

21 NOV 2012 PM 2

5185 00.450 NOV 21 12
6019 MAILED FROM ZIP CODE 85220

Bureau of Land Management
Arizona State Office
1 North Central Ave, Suite 800
Phoenix, Az. 85004

85004442700



United States Department of the Interior
Bureau of Land Management
 LANDS/RECREATION & PLANNING
 ONE N CENTRAL AVE
 PHOENIX, AZ 85004 -2203
 Phone: 602-417-9200

Receipt

No: 2695221

Transaction #: 2776984	
Date of Transaction: 11/26/2012	
CUSTOMER:	
DAN WARE PO BOX 1200 APACHE JUNCTION, AZ 85217-1200 US	

LINE #	QTY	DESCRIPTION	REMARKS	UNIT PRICE	TOTAL
1	1.00	LOCATABLE MINERALS / MINING CLAIMS-NOT NEW-UNADJUD, ONE AUTH NO. ONLY / MINING CLAIM MONEY RECEIVED CASES: AMC364399/\$140.00	ADDITIONAL MONIES FOR MAINT FEE PYMNT 2013	- n/a -	140.00
TOTAL:					\$140.00

PAYMENT INFORMATION			
1	AMOUNT:	140.00	POSTMARKED: 11/21/2012
	TYPE:	CHECK	RECEIVED: 11/26/2012
	CHECK NO:	1406	
	NAME:	SUPERSTITION MOUNTAIN TREASURE HUNTERS INC 940 W APACHE TRAIL APACHE JUNCTION AZ 85120 US	

REMARKS

This receipt was generated by the automated BLM Collections and Billing System and is a paper representation of a portion of the official electronic record contained therein.



United States Department of the Interior



BUREAU OF LAND MANAGEMENT

Arizona State Office

One North Central Avenue, Suite 800

Phoenix, Arizona 85004-4427

www.blm.gov/az/

November 2, 2012

In Reply Refer To:

3800 (9310) AT

AMC362401, AMC362442, AMC362705, **AMC364399**

CERTIFIED MAIL – RETURN RECEIPT REQUEST 7012 2210 0000 8675 2346

NOTICE

WARE DAN, ET AL
PO BOX 1200
APACHE JUNCTION, AZ 85117

This Notice Affects Those Claims
Shown in the Block Below.

AMC362401, 362442, 362444, 362445, 362705, 364399
M & M, B & B, RIO SECO, SOARING EAGLE 2, DESERT ROSE 1, STANTON ROCKER 1

2013 Maintenance Fees - Additional Fees Required

Your maintenance fee payment for the 2013 assessment year, in the amount of \$140 per claim, for the placer claims listed above, has been received and is insufficient. **The total due on your claim(s) is: \$\$3,500.**

In accordance with the Consolidated Appropriations Act of 2012, Public Law 112-74 (125 Stat 1047), and FR44155-44158 (2012) Congress changed the way maintenance fees for placer mining claims are assessed. Instead of charging the maintenance fee on a per-claim basis, Congress stated that the fee, which is currently \$140, will be assessed on each 20 acre parcel of a placer claim or portion thereof.

Insufficient payment of the annual maintenance fee for the 2013 assessment year is a curable defect. **Therefore you are required to do one of the following within 30 days of receipt of this notice or your claim(s) will be declared forfeited:** 1) submit additional fees of \$140 per 20-acres or portion thereof based on the full acreage of the claim, or 2) amend the claim(s) to reduce the acres so a lesser fee is due and submit any additional fees due; or 3) relinquish the claim(s) in their entirety, in which case BLM will refund the maintenance fees you have already paid for the 2013 assessment year.

If you choose to amend the claims to reduce the acres, you must submit an amended location notice for each claim, with an accurate description and dimensions of the reduced claim, along with a map depicting the reduced claim, and a \$10 processing fee per amendment. An amendment must also be recorded at the county. If the amended claim contains more than 20 acres, calculate the additional fees due and submit those fees with the amendment(s).

Amended 4

pd for 1

Rolling 1

AT

Please include your Arizona Mining Claim (AMC) serial number(s) and claim name(s) when submitting the additional fees, and note that you are paying additional fees due. If additional information is required, please contact Amy Thrower at 602-417-9334.

Rebecca Heick

Rebecca Heick
Group Administrator
Lands and Minerals

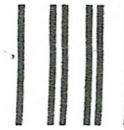

First-Class Mail
Postage & Fees Paid
USPS
Permit No. G-10

• Sender: Please print your name, address, and ZIP+4 in this box •

Bureau of Land Management
Arizona State Office
One North Central Avenue, Ste 800
Phoenix, AZ 85004-4427

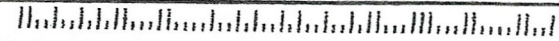

SENDER: COMPLETE THIS SECTION	COMPLETE THIS SECTION ON DELIVERY
<ul style="list-style-type: none"> Complete items 1, 2, and 3. Also complete item 4 if Restricted Delivery is desired. Print your name and address on the reverse so that we can return the card to you. Attach this card to the back of the mailpiece, or on the front if space permits. 	<p>A. Signature <input type="checkbox"/> Agent <input checked="" type="checkbox"/> Addressee</p>
<p>1. Article Addressed to:</p> <p>WARE DAN, ET AL PO BOX 1200 APACHE JUNCTION, AZ 85117</p> <p>AMC362401, 362442, 362444, 362445, 362705. 364399</p>	<p>B. Received by (Printed Name) <input type="checkbox"/> Agent DAN WARE <input type="checkbox"/> Addressee</p> <p>C. Date of Delivery</p>
<p>2. Article Number (Transfer from service label)</p>	<p>D. Is delivery address different from item 1? <input type="checkbox"/> Yes If YES, enter delivery address below: <input type="checkbox"/> No</p>
	<p>3. Service Type</p> <p><input type="checkbox"/> Certified Mail <input type="checkbox"/> Express Mail <input type="checkbox"/> Registered <input type="checkbox"/> Return Receipt for Merchandise <input type="checkbox"/> Insured Mail <input type="checkbox"/> C.O.D.</p>
	<p>4. Restricted Delivery? (Extra Fee) <input type="checkbox"/> Yes</p>
	<p>7012 2210 0000 8675 2346</p>

*RZ 12/15/11
JD 12/15/2011
R/Herak 12/15/11*

DEC 16 2011

In Reply Refer To:
3800 (9330) RE
AMC364399

CERTIFIED MAIL – RETURN RECEIPT REQUESTED

DECISION

✓ Dan Ware	:	AMC364399
P.O. Box 1200	:	Stanton Rocker I
Apache Junction, Arizona 85117-4048	:	
CM-RRR # 70112970 0001 7938 2029	:	
	:	
Joseph R. Grieger	:	
7222 E. Jasmine St.	:	
Mesa, Arizona 85207	:	
CM-RRR # 7011 2970 0001 7938 2036	:	
	:	
✓ Leonard Derocher	:	
5087 Crested Saguaro Ln.	:	
Gold Canyon, Arizona 85218	:	
CM-RRR # 7011 2970 0001 7938 2043	:	
	:	
✓ Ted Montague <i>12/20</i>	:	
4826 N. Valley Dr.	:	
Apache Junction, Arizona 85120-8755	:	
CM-RRR # 7011 2970 0001 7938 2050	:	

Decision Vacated

The decision of December 8, 2011, declaring the above listed mining claim forfeited for failure to file the required maintenance fee payment or small miner's maintenance fee waiver on or before September 1, 2011, is hereby vacated.

SENDER: COMPLETE THIS SECTION

- Complete items 1, 2, and 3. Also complete item 4 if Restricted Delivery is desired.
- Print your name and address on the reverse so that we can return the card to you.
- Attach this card to the back of the mailpiece, or on the front if space permits.

1. Article Addressed to:

Leonard Derocher
 5087 Crested Saguaro Ln.
 Gold Canyon, Arizona 85218
 9310 RE AMC364399

2. Article Number

(Transfer from service label)

7011 2970 0001 7938 2043

COMPLETE THIS SECTION ON DELIVERY

A. Signature

X

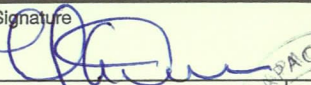
 Agent
 Addressee
B. Received by (*Printed Name*)

LEONARD A. DEROCHE

C. Date of Delivery

D. Is delivery address different from item 1?

 Yes

If YES, enter delivery address below:

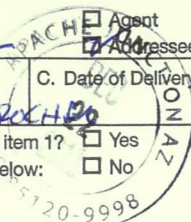
 No

3. Service Type

 Certified Mail Express Mail Registered Return Receipt for Merchandise Insured Mail C.O.D.4. Restricted Delivery? (*Extra Fee*) Yes

UNITED STATES POSTAL SERVICE

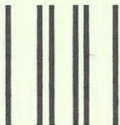

First-Class Mail
Postage & Fees Paid
USPS
Permit No. G-10

• Sender: Please print your name, address, and ZIP+4 in this box •

RECEIVED
BLM AZ STATE OFFICE

2011 DEC 23 PM 12: 29

PHOENIX, ARIZONA

BUREAU OF LAND MANAGEMENT
ARIZONA STATE OFFICE
ONE NORTH CENTRAL AVENUE
SUITE 800
PHOENIX, AZ 85004-2203



SENDER: COMPLETE THIS SECTION

- Complete items 1, 2, and 3. Also complete item 4 if Restricted Delivery is desired.
- Print your name and address on the reverse so that we can return the card to you.
- Attach this card to the back of the mailpiece, or on the front if space permits.

1. Article Addressed to:

Dan Ware
 P.O. Box 1200
 Apache Junction, AZ 85117-4048
 9310 RE AMC364399

2. Article Number

(Transfer from service label)

7011 2970 0001 7938 2029

COMPLETE THIS SECTION ON DELIVERY

A. Signature

Mrs. Dan Ware Agent
 Addressee

B. Received by (Printed Name)

MRS DAN WARE

C. Date of Delivery

12-22-11

D. Is delivery address different from item 1? YesIf YES, enter delivery address below: No

3. Service Type

- Certified Mail Express Mail
 Registered Return Receipt for Merchandise
 Insured Mail C.O.D.

4. Restricted Delivery? (Extra Fee)

 Yes

UNITED STATES POSTAL SERVICE



First-Class Mail
Postage & Fees Paid
USPS
Permit No. G-10

- Sender: Please print your name, address, and ZIP+4 in this box •

RECEIVED
BLM AZ STATE OFFICE

2011 DEC 23 PM 12: 29

PHOENIX, ARIZONA

BUREAU OF LAND MANAGEMENT
ARIZONA STATE OFFICE
ONE NORTH CENTRAL AVENUE
SUITE 800
PHOENIX, AZ 85004-2203



SENDER: COMPLETE THIS SECTION

- Complete items 1, 2, and 3. Also complete item 4 if Restricted Delivery is desired.
- Print your name and address on the reverse so that we can return the card to you.
- Attach this card to the back of the mailpiece, or on the front if space permits.

1. Article Addressed to:

Ted Montague
 4826 N. Valley Dr.
 Apache Junction, AZ 85120-8755
 9310 RE AMC364399

2. Article Number

(Transfer from service label)

7011 2970 0001 7938 2050

COMPLETE THIS SECTION ON DELIVERY

A. Signature

X

 Agent Addressee

B. Received by (Printed Name)

TED MONTAGUE

C. Date of Delivery

12-20-11

D. Is delivery address different from item 1? Yes

If YES, enter delivery address below:

 No

3. Service Type

 Certified Mail Express Mail Registered Return Receipt for Merchandise Insured Mail C.O.D.

4. Restricted Delivery? (Extra Fee)

 Yes

UNITED STATES POSTAL SERVICE



First-Class Mail
Postage & Fees Paid
USPS
Permit No. G-10

- Sender: Please print your name, address, and ZIP+4 in this box •

BUREAU OF LAND MANAGEMENT
ARIZONA STATE OFFICE
ONE NORTH CENTRAL AVENUE
SUITE 800
PHOENIX, AZ 85004-2203

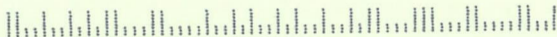

SENDER: COMPLETE THIS SECTION

- Complete items 1, 2, and 3. Also complete item 4 if Restricted Delivery is desired.
- Print your name and address on the reverse so that we can return the card to you.
- Attach this card to the back of the mailpiece, or on the front if space permits.

1. Article Addressed to:

Joseph R. Grieger
 7222 E. Jasmine St.
 Mesa, Arizona 85207
 9310 RE AMC364399

 2. Article Number
 (Transfer from service label)

7011 2970 0001 7938 2036

COMPLETE THIS SECTION ON DELIVERY

A. Signature

X

 Agent Addressee

B. Received by (Printed Name)

JOSEPH R. GRIEGER

C. Date of Delivery

D. Is delivery address different from item 1? YesIf YES, enter delivery address below: No

3. Service Type

 Certified Mail Express Mail Registered Return Receipt for Merchandise Insured Mail C.O.D.

4. Restricted Delivery? (Extra Fee)

 Yes

UNITED STATES POSTAL SERVICE



First-Class Mail
Postage & Fees Paid
USPS
Permit No. G-10

- Sender: Please print your name, address, and ZIP+4 in this box •

BUREAU OF LAND MANAGEMENT
ARIZONA STATE OFFICE
ONE NORTH CENTRAL AVENUE
SUITE 800
PHOENIX, AZ 85004-2203

RECEIVED
BLM ARIZONA STATE OFFICE
JAN -9 PM 1:56

PHOENIX, ARIZONA

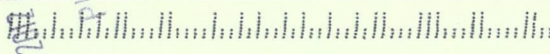

Documentation shows a timely filed maintenance fee payment was received. Our records have been updated to show the claim in a current status. Enclosed are copies of your serial register page.

If additional information is required, please contact Rod Ebert at 602-417-9397.

/s/ Rebecca Heick

Rebecca Heick
Group Administrator
Lands and Minerals

Enclosure

REbert:lm:121511

December 8, 2011

In Reply Refer To:
3800 (9310) RE
AMC364399

CERTIFIED MAIL - RETURN RECEIPT REQUESTED No. 7011 2000 0002 6863 2837

DECISION

MONTAGUE TED	:	This decision affects those claims shown
4826 N VALLEY DR	:	in the block below:
APACHE JUNCTION, AZ 85120-8755	:	

AMC364399
STANTON ROCKER 1

MINING CLAIMS
DECLARED FORFEITED

The mining claims listed above have been declared forfeited for failure to file the required maintenance fee payment or small miner's maintenance fee waiver (waiver).

Claimants are required to pay an annual non-refundable maintenance fee of \$140, or submit a waiver, on or before September 1 of each year. These requirements were established by 30 (United States Code) 28-f-k, as amended, and 43 Code of Federal Regulations (CFR) 3834 and 3835.

Our records do not show receipt of a maintenance fee payment, or waiver received on or before September 1, 2011, for the 2012 assessment year, for the claims listed above. Therefore, the claims are forfeited.

This decision does not relieve you of the liability for reclamation of all areas disturbed by your activities on lands covered by the subject mining claim(s) and/or site(s). After you complete the reclamation, you must notify the authorized officer of the appropriate surface managing agency so that the authorized officer may conduct a final site inspection and determine whether you may be released from liability.

*Decision Vacated
Paperwork erroneously entered
as AMC 362399 & paperwork
misfiled in 362399
P2 12/19/11*

SENDER: COMPLETE THIS SECTION

- Complete items 1, 2, and 3. Also complete item 4 if Restricted Delivery is desired.
- Print your name and address on the reverse so that we can return the card to you.
- Attach this card to the back of the mailpiece, or on the front if space permits.

1. Article Addressed to:

MONTAGUE TED
 4826 N VALLEY DR
 APACHE JUNCTION, AZ 85120-8755
 9310 RE AMC364399

2. Article Number

(Transfer from service label)

7011 2000 0002 6863 2837

COMPLETE THIS SECTION ON DELIVERY

A. Signature

Addressee Agent
 X Ted Montague

B. Received by (Printed Name)

Ted Montague

C. Date of Delivery

12/10/11

D. Is delivery address different from item 1? YesIf YES, enter delivery address below: No

3. Service Type

- | | |
|---|---|
| <input type="checkbox"/> Certified Mail | <input type="checkbox"/> Express Mail |
| <input type="checkbox"/> Registered | <input type="checkbox"/> Return Receipt for Merchandise |
| <input type="checkbox"/> Insured Mail | <input type="checkbox"/> C.O.D. |

4. Restricted Delivery? (Extra Fee)

 Yes

UNITED STATES POSTAL SERVICE



First-Class Mail
Postage & Fees Paid
USPS
Permit No. G-10

- Sender: Please print your name, address, and ZIP+4 in this box •

BUREAU OF LAND MANAGEMENT
ARIZONA STATE OFFICE
ONE NORTH CENTRAL AVENUE
SUITE 800
PHOENIX, AZ 85004-2203



If you fail to reclaim the land to the satisfaction of the authorized officer, the surface management agency may cite you for noncompliance under its surface management regulations.

For land administered by the Bureau of Land Management (BLM), if you fail to reclaim the land to the satisfaction of the authorized officer as required in 43 CFR Subpart 3809, BLM will issue an order of noncompliance under 43 CFR 3809.601(a). If you fail to comply with the noncompliance order, BLM may take further action under 43 CFR 3809.604. Failure to conduct reclamation is a prohibited act that may subject you to criminal penalties. See 43 CFR 3809.605(h) and 43 CFR 3809.700.

This decision may be appealed to the Interior Board of Land Appeals, Office of the Secretary, in accordance with the regulations contained in 43 CFR, Part 4, and the enclosed Form 1842-1. If an appeal is taken, your notice of appeal must be filed in this office (at the above address) within 30 days from receipt of this decision. The appellant has the burden of showing that the decision appealed from is in error.

If you wish to file a petition pursuant to regulation 43 CFR 4.21 (58 FR 4939, January 19, 1993) for a stay of the effectiveness of this decision during the time that your appeal is being reviewed by the Board, the petition for a stay must accompany your notice of appeal. A petition for a stay is required to show sufficient justification based on the standards listed below. Copies of the notice of appeal and petition for a stay **must** also be submitted to each party named in this decision and to the Interior Board of Land Appeals and to the appropriate Office of the Solicitor (see 43 CFR 4.413) at the same time the original documents are filed with this office. If you request a stay, you have the burden of proof to demonstrate that a stay should be granted.

Standards for Obtaining a Stay

Except as otherwise provided by law or other pertinent regulation, a petition for a stay of a decision pending appeal shall show sufficient justification based on the following standards:

- (1) The relative harm to the parties if the stay is granted or denied,
- (2) The likelihood of the appellant's success on the merits,
- (3) The likelihood of immediate and irreparable harm if the stay is not granted, and
- (4) Whether the public interest favors granting the stay.

Please include your AMC serial number(s) on all correspondence. If additional information is required, please call Rod Ebert at 602-417-9397.

/s/ Rebecca Heick

Rebecca Heick
Group Administrator
Lands and Minerals

Enclosure
REbert:lm:120811

December 8, 2011

In Reply Refer To:
3800 (9310) RE
AMC364399

CERTIFIED MAIL - RETURN RECEIPT REQUESTED No. 7011 2000 0002 6863 2844

DECISION

DEROCHER LEONARD
5087 CRESTED SAGUARO LN
GOLD CANYON, AZ 85218

: This decision affects those claims shown
: in the block below:
:

AMC364399
STANTON ROCKER 1

MINING CLAIMS
DECLARED FORFEITED

The mining claims listed above have been declared forfeited for failure to file the required maintenance fee payment or small miner's maintenance fee waiver (waiver).

Claimants are required to pay an annual non-refundable maintenance fee of \$140, or submit a waiver, on or before September 1 of each year. These requirements were established by 30 (United States Code) 28-f-k, as amended, and 43 Code of Federal Regulations (CFR) 3834 and 3835.

Our records do not show receipt of a maintenance fee payment, or waiver received on or before September 1, 2011, for the 2012 assessment year, for the claims listed above. Therefore, the claims are forfeited.

This decision does not relieve you of the liability for reclamation of all areas disturbed by your activities on lands covered by the subject mining claim(s) and/or site(s). After you complete the reclamation, you must notify the authorized officer of the appropriate surface managing agency so that the authorized officer may conduct a final site inspection and determine whether you may be released from liability.

Decision Vacated
78 Claim erroneously entered
12/19/11 as AMC 362399 paperwork
was filed in same headcase file

SENDER: COMPLETE THIS SECTION

- Complete items 1, 2, and 3. Also complete item 4 if Restricted Delivery is desired.
- Print your name and address on the reverse so that we can return the card to you.
- Attach this card to the back of the mailpiece, or on the front if space permits.

1. Article Addressed to:

DEROCHER LEONARD
 5087 CRESTED SAGUARO LN
 GOLD CANYON, AZ 85218
 9310 RE AMC364399

2. Article Number

(Transfer from service label)

7011 2000 0002 6863 2844

COMPLETE THIS SECTION ON DELIVERY

A. Signature

X

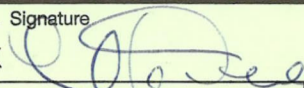
 Agent AddresseeB. Received by (*Printed Name*)

C. Date of Delivery

 D. Is delivery address different from item 1? Yes
 If YES, enter delivery address below: No

3. Service Type

 Certified Mail Express Mail Registered Return Receipt for Merchandise Insured Mail C.O.D.4. Restricted Delivery? (*Extra Fee*) Yes

UNITED STATES POSTAL SERVICE

13 DEC 2011 PM 6 L



First-Class Mail
Postage & Fees Paid
USPS
Permit No. G-10

• Sender: Please print your name, address, and ZIP+4 in this box •

RECEIVED
BLM AZ STATE OFFICE

2011 DEC 14 PM 1:43

PHOENIX, ARIZONA

BUREAU OF LAND MANAGEMENT
ARIZONA STATE OFFICE
ONE NORTH CENTRAL AVENUE
SUITE 800
PHOENIX, AZ 85004-2203

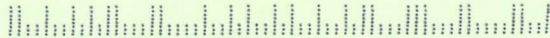

If you fail to reclaim the land to the satisfaction of the authorized officer, the surface management agency may cite you for noncompliance under its surface management regulations.

For land administered by the Bureau of Land Management (BLM), if you fail to reclaim the land to the satisfaction of the authorized officer as required in 43 CFR Subpart 3809, BLM will issue an order of noncompliance under 43 CFR 3809.601(a). If you fail to comply with the noncompliance order, BLM may take further action under 43 CFR 3809.604. Failure to conduct reclamation is a prohibited act that may subject you to criminal penalties. See 43 CFR 3809.605(h) and 43 CFR 3809.700.

This decision may be appealed to the Interior Board of Land Appeals, Office of the Secretary, in accordance with the regulations contained in 43 CFR, Part 4, and the enclosed Form 1842-1. If an appeal is taken, your notice of appeal must be filed in this office (at the above address) within 30 days from receipt of this decision. The appellant has the burden of showing that the decision appealed from is in error.

If you wish to file a petition pursuant to regulation 43 CFR 4.21 (58 FR 4939, January 19, 1993) for a stay of the effectiveness of this decision during the time that your appeal is being reviewed by the Board, the petition for a stay must accompany your notice of appeal. A petition for a stay is required to show sufficient justification based on the standards listed below. Copies of the notice of appeal and petition for a stay **must** also be submitted to each party named in this decision and to the Interior Board of Land Appeals and to the appropriate Office of the Solicitor (see 43 CFR 4.413) at the same time the original documents are filed with this office. If you request a stay, you have the burden of proof to demonstrate that a stay should be granted.

Standards for Obtaining a Stay

Except as otherwise provided by law or other pertinent regulation, a petition for a stay of a decision pending appeal shall show sufficient justification based on the following standards:

- (1) The relative harm to the parties if the stay is granted or denied,
- (2) The likelihood of the appellant's success on the merits,
- (3) The likelihood of immediate and irreparable harm if the stay is not granted, and
- (4) Whether the public interest favors granting the stay.

Please include your AMC serial number(s) on all correspondence. If additional information is required, please call Rod Ebert at 602-417-9397.

/s/ Rebecca Heick

Rebecca Heick
Group Administrator
Lands and Minerals

Enclosure
REbert:lm:120811

December 8, 2011

In Reply Refer To:
3800 (9310) RE
AMC364399

CERTIFIED MAIL - RETURN RECEIPT REQUESTED No. 7011 2000 0002 6863 2868

DECISION

WARE DAN
PO BOX 1200
APACHE JUNCTION, AZ 85117-4048

: This decision affects those claims shown
: in the block below:
:

AMC364399
STANTON ROCKER 1

MINING CLAIMS
DECLARED FORFEITED

The mining claims listed above have been declared forfeited for failure to file the required maintenance fee payment or small miner's maintenance fee waiver (waiver).

Claimants are required to pay an annual non-refundable maintenance fee of \$140, or submit a waiver, on or before September 1 of each year. These requirements were established by 30 (United States Code) 28-f-k, as amended, and 43 Code of Federal Regulations (CFR) 3834 and 3835.

Our records do not show receipt of a maintenance fee payment, or waiver received on or before September 1, 2011, for the 2012 assessment year, for the claims listed above. Therefore, the claims are forfeited.

This decision does not relieve you of the liability for reclamation of all areas disturbed by your activities on lands covered by the subject mining claim(s) and/or site(s). After you complete the reclamation, you must notify the authorized officer of the appropriate surface managing agency so that the authorized officer may conduct a final site inspection and determine whether you may be released from liability.

DECISION UNDATED
Claim misentered
RE as AMC 362399 2 paperwork
12/14/11 filed in case file for the same

SENDER: COMPLETE THIS SECTION

- Complete items 1, 2, and 3. Also complete item 4 if Restricted Delivery is desired.
- Print your name and address on the reverse so that we can return the card to you.
- Attach this card to the back of the mailpiece, or on the front if space permits.

1. Article Addressed to:

WARE DAN
 PO BOX 1200
 APACHE JUNCTION, AZ 85117-4048
 9310 RE AMC364399

 2. Article Number
(Transfer from service label)

7011 2000 0002 6863 2868

COMPLETE THIS SECTION ON DELIVERY

A. Signature

X

 Agent AddresseeB. Received by (*Printed Name*)

DAN WARE

C. Date of Delivery

12-14-11

 D. Is delivery address different from item 1? Yes
 If YES, enter delivery address below: No

3. Service Type

 Certified Mail Express Mail Registered Return Receipt for Merchandise Insured Mail C.O.D.4. Restricted Delivery? (*Extra Fee*) Yes

UNITED STATES POSTAL SERVICE

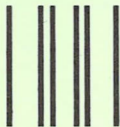

First-Class Mail
Postage & Fees Paid
USPS
Permit No. G-10

• Sender: Please print your name, address, and ZIP+4 in this box •

RECEIVED
BLM AZ STATE OFFICE

2011 DEC 15 PM 2:37

PHOENIX, ARIZONA

BUREAU OF LAND MANAGEMENT
ARIZONA STATE OFFICE
ONE NORTH CENTRAL AVENUE
SUITE 800
PHOENIX, AZ 85004-2203

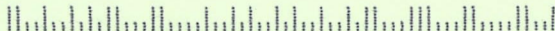

If you fail to reclaim the land to the satisfaction of the authorized officer, the surface management agency may cite you for noncompliance under its surface management regulations.

For land administered by the Bureau of Land Management (BLM), if you fail to reclaim the land to the satisfaction of the authorized officer as required in 43 CFR Subpart 3809, BLM will issue an order of noncompliance under 43 CFR 3809.601(a). If you fail to comply with the noncompliance order, BLM may take further action under 43 CFR 3809.604. Failure to conduct reclamation is a prohibited act that may subject you to criminal penalties. See 43 CFR 3809.605(h) and 43 CFR 3809.700.

This decision may be appealed to the Interior Board of Land Appeals, Office of the Secretary, in accordance with the regulations contained in 43 CFR, Part 4, and the enclosed Form 1842-1. If an appeal is taken, your notice of appeal must be filed in this office (at the above address) within 30 days from receipt of this decision. The appellant has the burden of showing that the decision appealed from is in error.

If you wish to file a petition pursuant to regulation 43 CFR 4.21 (58 FR 4939, January 19, 1993) for a stay of the effectiveness of this decision during the time that your appeal is being reviewed by the Board, the petition for a stay must accompany your notice of appeal. A petition for a stay is required to show sufficient justification based on the standards listed below. Copies of the notice of appeal and petition for a stay **must** also be submitted to each party named in this decision and to the Interior Board of Land Appeals and to the appropriate Office of the Solicitor (see 43 CFR 4.413) at the same time the original documents are filed with this office. If you request a stay, you have the burden of proof to demonstrate that a stay should be granted.

Standards for Obtaining a Stay

Except as otherwise provided by law or other pertinent regulation, a petition for a stay of a decision pending appeal shall show sufficient justification based on the following standards:

- (1) The relative harm to the parties if the stay is granted or denied,
- (2) The likelihood of the appellant's success on the merits,
- (3) The likelihood of immediate and irreparable harm if the stay is not granted, and
- (4) Whether the public interest favors granting the stay.

Please include your AMC serial number(s) on all correspondence. If additional information is required, please call Rod Ebert at 602-417-9397.

/s/ Rebecca Heick

Rebecca Heick
Group Administrator
Lands and Minerals

Enclosure
REbert:lm:120811

December 8, 2011

In Reply Refer To:
3800 (9310) RE
AMC364399

CERTIFIED MAIL - RETURN RECEIPT REQUESTED No. 7011 2000 0002 6863 2851

DECISION

GRIEGER JOSEPH R
7222 E JASMINE ST
MESA, AZ 85207

: This decision affects those claims shown
: in the block below:
:

AMC364399
STANTON ROCKER 1

MINING CLAIMS
DECLARED FORFEITED

The mining claims listed above have been declared forfeited for failure to file the required maintenance fee payment or small miner's maintenance fee waiver (waiver).

Claimants are required to pay an annual non-refundable maintenance fee of \$140, or submit a waiver, on or before September 1 of each year. These requirements were established by 30 (United States Code) 28-f-k, as amended, and 43 Code of Federal Regulations (CFR) 3834 and 3835.

Our records do not show receipt of a maintenance fee payment, or waiver received on or before September 1, 2011, for the 2012 assessment year, for the claims listed above. Therefore, the claims are forfeited.

This decision does not relieve you of the liability for reclamation of all areas disturbed by your activities on lands covered by the subject mining claim(s) and/or site(s). After you complete the reclamation, you must notify the authorized officer of the appropriate surface managing agency so that the authorized officer may conduct a final site inspection and determine whether you may be released from liability.

RE 12/14/11 DECISION VACATED
Claim misentered as
AMC 362399 & filed in
that casefile. *[Signature]*

SENDER: COMPLETE THIS SECTION

- Complete items 1, 2, and 3. Also complete item 4 if Restricted Delivery is desired.
- Print your name and address on the reverse so that we can return the card to you.
- Attach this card to the back of the mailpiece, or on the front if space permits.

1. Article Addressed to:

GRIEGER JOSEPH R
 7222 E JASMINE ST
 MESA, AZ 85207
 9310 RE AMC364399

 2. Article Number
 (Transfer from service label)

7011 2000 0002 6863 2851

COMPLETE THIS SECTION ON DELIVERY

A. Signature

X

Joseph R Grieger

 Agent Addressee

B. Received by (Printed Name)

JOSEPH R. GRIEGER

C. Date of Delivery

12-10-11

D. Is delivery address different from item 1? YesIf YES, enter delivery address below: No

3. Service Type

 Certified Mail Express Mail Registered Return Receipt for Merchandise Insured Mail C.O.D.

4. Restricted Delivery? (Extra Fee)

 Yes

If you fail to reclaim the land to the satisfaction of the authorized officer, the surface management agency may cite you for noncompliance under its surface management regulations.

For land administered by the Bureau of Land Management (BLM), if you fail to reclaim the land to the satisfaction of the authorized officer as required in 43 CFR Subpart 3809, BLM will issue an order of noncompliance under 43 CFR 3809.601(a). If you fail to comply with the noncompliance order, BLM may take further action under 43 CFR 3809.604. Failure to conduct reclamation is a prohibited act that may subject you to criminal penalties. See 43 CFR 3809.605(h) and 43 CFR 3809.700.

This decision may be appealed to the Interior Board of Land Appeals, Office of the Secretary, in accordance with the regulations contained in 43 CFR, Part 4, and the enclosed Form 1842-1. If an appeal is taken, your notice of appeal must be filed in this office (at the above address) within 30 days from receipt of this decision. The appellant has the burden of showing that the decision appealed from is in error.

If you wish to file a petition pursuant to regulation 43 CFR 4.21 (58 FR 4939, January 19, 1993) for a stay of the effectiveness of this decision during the time that your appeal is being reviewed by the Board, the petition for a stay must accompany your notice of appeal. A petition for a stay is required to show sufficient justification based on the standards listed below. Copies of the notice of appeal and petition for a stay **must** also be submitted to each party named in this decision and to the Interior Board of Land Appeals and to the appropriate Office of the Solicitor (see 43 CFR 4.413) at the same time the original documents are filed with this office. If you request a stay, you have the burden of proof to demonstrate that a stay should be granted.

Standards for Obtaining a Stay

Except as otherwise provided by law or other pertinent regulation, a petition for a stay of a decision pending appeal shall show sufficient justification based on the following standards:

- (1) The relative harm to the parties if the stay is granted or denied,
- (2) The likelihood of the appellant's success on the merits,
- (3) The likelihood of immediate and irreparable harm if the stay is not granted, and
- (4) Whether the public interest favors granting the stay.

Please include your AMC serial number(s) on all correspondence. If additional information is required, please call Rod Ebert at 602-417-9397.

/s/ Rebecca Heick

Rebecca Heick
Group Administrator
Lands and Minerals

Enclosure
REbert:lm:120811

3/23/2010
AT 3/23/10
mhm 3/24/10

MAR 24 2010

In Reply Refer To:
3800 (9310) TS
AMC364399

CERTIFIED MAIL - RETURN RECEIPT REQUESTED No.

DECISION

Dan Ware
370 N Winchester Rd
Apache Junction, Arizona 85219
RR# 7005 1160 0003 7539 7509

AMC364399
STANTON ROCKER 1

✓ Joseph Grieger
7222 E Jasmine St
Mesa, Arizona 85207
RR# 7005 1160 0003 7540 0018

Leonard Derocher
5087 Crested Saguaro Ln.
Gold Canyon, Arizona 85218
RR# 7005 1160 0003 7540 0025

✓ Ted Montague
4826 N Valley Dr.
Apache Junction, Arizona 85120-8755
RR# 7099 3220 0003 6896 9939

Decision Vacated

The decision of March 17, 2010, declaring the above listed mining claim forfeited for failure to file the required maintenance fee payment or small miner's maintenance fee waiver (waiver) is hereby vacated.

The maintenance fee payment was applied to the wrong AMC number in error. This error has been corrected and our records have been updated to show the claim is current for the 2010 assessment year.

SENDER: COMPLETE THIS SECTION

- Complete items 1, 2, and 3. Also complete item 4 if Restricted Delivery is desired.
- Print your name and address on the reverse so that we can return the card to you.
- Attach this card to the back of the mailpiece, or on the front if space permits.

1. Article Addressed to:

Joseph Grieger
 7222 E Jasmine St
 Mesa, Arizona 85207
 AZ933 TS AMC364399

 2. Article Number
 (Transfer from service label)

7005 1160 0003 7540 0018

COMPLETE THIS SECTION ON DELIVERY

A. Signature

 X *Joseph E. Grieger*
 Agent
 Addressee

B. Received by (Printed Name)

C. Date of Delivery

3/26/10

 D. Is delivery address different from item 1? Yes
 If YES, enter delivery address below: No

3. Service Type

-
- Certified Mail
-
- Express Mail
-
-
- Registered
-
- Return Receipt for Merchandise
-
-
- Insured Mail
-
- C.O.D.

4. Restricted Delivery? (Extra Fee)

 Yes

UNITED STATES POSTAL SERVICE



First-Class Mail
Postage & Fees Paid
USPS
Permit No. G-10

RECEIVED
BLM AZ STATE OFFICE

2010 MAR 30 P 2:34

PHOENIX ARIZONA

• Sender: Please print your name, address, and ZIP+4 in this box •

**U.S. DEPARTMENT OF THE INTERIOR
BUREAU OF LAND MANAGEMENT
ARIZONA STATE OFFICE
ONE NORTH CENTRAL AVENUE, SUITE 800
PHOENIX, AZ 85004-4427**



3/26/10

SENDER: COMPLETE THIS SECTION

- Complete items 1, 2, and 3. Also complete item 4 if Restricted Delivery is desired.
- Print your name and address on the reverse so that we can return the card to you.
- Attach this card to the back of the mailpiece, or on the front if space permits.

1. Article Addressed to:

Ted Montague
 4826 N Valley Dr.
 Apache Junction, AZ 85120-8755
 AZ933 TS AMC364399

2. Article Number
 (Transfer from service label)

7099 3220 0003 6896 9939

COMPLETE THIS SECTION ON DELIVERY

A. Signature Agent
 Martha Montague Addressee

B. Received by (Printed Name) C. Date of Delivery
 Martha Montague

D. Is delivery address different from item 1? Yes
 If YES, enter delivery address below: No

3. Service Type
 Certified Mail Express Mail
 Registered Return Receipt for Merchandise
 Insured Mail C.O.D.

4. Restricted Delivery? (Extra Fee) Yes

UNITED STATES POSTAL SERVICE



First-Class Mail
Postage & Fees Paid
USPS
Permit No. G-10

- Sender: Please print your name, address, and ZIP+4 in this box •

RECEIVED
BLM AZ STATE OFFICE

2010 MAR 30 P 2:34

PHOENIX, ARIZONA

U.S. DEPARTMENT OF THE INTERIOR
BUREAU OF LAND MANAGEMENT
ARIZONA STATE OFFICE
ONE NORTH CENTRAL AVENUE, SUITE 800
PHOENIX, AZ 85004-4427

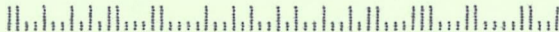

Please include your AMC serial number(s) on all correspondence. If you have questions, please contact Tony Smith at 602-417-9355.

Angela Mogel
Acting Group Administrator
Renewable and Mineral Resources

TS:lm:032310



United States Department of the Interior



BUREAU OF LAND MANAGEMENT

Arizona State Office

One North Central Avenue, Suite 800

Phoenix, Arizona 85004-4427

www.blm.gov/az/

March 24, 2010

In Reply Refer To:
3800 (9310) TS
AMC364399

CERTIFIED MAIL - RETURN RECEIPT REQUESTED No.

DECISION

✓ Dan Ware	:	AMC364399
370 N Winchester Rd	:	STANTON ROCKER 1
Apache Junction, Arizona 85219	:	
RR# 7005 1160 0003 7539 7509	:	
Joseph Grieger	:	
7222 E Jasmine St	:	
Mesa, Arizona 85207	:	
RR# 7005 1160 0003 7540 0018	:	
✓ Leonard Derocher	:	
5087 Crested Saguaro Ln.	:	
Gold Canyon, Arizona 85218	:	
RR# 7005 1160 0003 7540 0025	:	
Ted Montague	:	
4826 N Valley Dr.	:	
Apache Junction, Arizona 85120-8755	:	
RR# 7099 3220 0003 6896 9939	:	

Decision Vacated

The decision of March 17, 2010, declaring the above listed mining claim forfeited for failure to file the required maintenance fee payment or small miner's maintenance fee waiver (waiver) is hereby vacated.

The maintenance fee payment was applied to the wrong AMC number in error. This error has been corrected and our records have been updated to show the claim is current for the 2010 assessment year.

Please include your AMC serial number(s) on all correspondence. If you have questions, please contact Tony Smith at 602-417-9355.

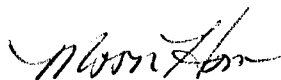

for Angela Mogel
Acting Group Administrator
Renewable and Mineral Resources

UNITED STATES
DEPARTMENT OF THE INTERIOR
Bureau of Land Management
Arizona State Office
One N. Central Avenue, Suite 800
Phoenix, AZ 85004-4427

AN E

CERTIFIED MAIL™



7005 1160 0003 7540 0025



UNITED STATES POSTAGE
U.S. OFFICIAL MAIL
PENALTY FOR PRIVATE USE \$300
PITNEY BOWLES
02 1A
0004205804 MAR 25 2010
MAILED FROM ZIP CODE 85004

\$ 05.54

RECEIVED
BLM AZ STATE OFFICE
2010 APR 15 PM 2:24
PHOENIX, ARIZONA
OFFICIAL BUSINESS
PENALTY FOR PRIVATE USE \$300

Leonard Derocher
Leonard Derocher
5087 Crested Saguaro Ln.
Gold Canyon, Arizona 85218
AZ933 TS AMC364399

NIXIE 850 SE 1 78 04/13/10

RETURN TO SENDER
UNCLAIMED
UNABLE TO FORWARD

BC: 85004442700 *0114-00748-25-41

85004442700

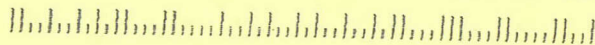

PLACE STICKER AT TOP OF ENVELOPE TO THE RIGHT
OF THE RETURN ADDRESS, FOLD AT DOTTED LINE

SENDER: COMPLETE THIS SECTION

- Complete items 1, 2, and 3. Also complete item 4 if Restricted Delivery is desired.
- Print your name and address on the reverse so that we can return the card to you.
- Attach this card to the back of the mailpiece, or on the front if space permits.

1. Article Addressed to:

Leonard Derocher
5087 Crested Saguaro Ln.
Gold Canyon, Arizona 85218
AZ933 TS AMC364399

2. Article Number
(Transfer from service label)

7005 1160 0003 7540 0025

PS Form 3811, February 2004

Domestic Return Receipt

102595-02-M-1540

COMPLETE THIS SECTION ON DELIVERY

A. Signature Agent
X Addressee

B. Received by (Printed Name)

C. Date of Delivery

D. Is delivery address different from item 1? Yes
If YES, enter delivery address below: No

3. Service Type

- Certified Mail Express Mail
- Registered Return Receipt for Merchandise
- Insured Mail C.O.D.

4. Restricted Delivery? (Extra Fee) Yes



United States Department of the Interior



BUREAU OF LAND MANAGEMENT
Arizona State Office
One North Central Avenue, Suite 800
Phoenix, Arizona 85004-4427
www.blm.gov/az/

March 24, 2010

In Reply Refer To:
3800 (9310) TS
AMC364399

CERTIFIED MAIL - RETURN RECEIPT REQUESTED No.

DECISION

Dan Ware	:	AMC364399
370 N Winchester Rd	:	STANTON ROCKER 1
Apache Junction, Arizona 85219	:	
RR# 7005 1160 0003 7539 7509	:	
	:	
Joseph Grieger	:	
7222 E Jasmine St	:	
Mesa, Arizona 85207	:	
RR# 7005 1160 0003 7540 0018	:	
	:	
Leonard Derocher	:	
5087 Crested Saguaro Ln.	:	
Gold Canyon, Arizona 85218	:	
RR# 7005 1160 0003 7540 0025	:	
	:	
Ted Montague	:	
4826 N Valley Dr.	:	
Apache Junction, Arizona 85120-8755	:	
RR# 7099 3220 0003 6896 9939	:	

Decision Vacated

The decision of March 17, 2010, declaring the above listed mining claim forfeited for failure to file the required maintenance fee payment or small miner's maintenance fee waiver (waiver) is hereby vacated.

The maintenance fee payment was applied to the wrong AMC number in error. This error has been corrected and our records have been updated to show the claim is current for the 2010 assessment year.

Please include your AMC serial number(s) on all correspondence. If you have questions, please contact Tony Smith at 602-417-9355.

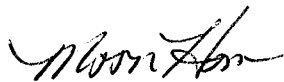

for Angela Mogel
Acting Group Administrator
Renewable and Mineral Resources

UNITED STATES
DEPARTMENT OF THE INTERIOR
Bureau of Land Management
Arizona State Office
One N. Central Avenue, Suite 800
Phoenix, AZ 85004-4427

AN EQU

CERTIFIED MAIL™



7005 1160 0003 7539 7509



UNITED STATES POSTAGE
U.S. OFFICIAL MAIL
PENALTY FOR PRIVATE USE \$300
PITNEY BOWES
02 1A
0004205804
MAILED FROM ZIP CODE 85004
\$ 05.54⁰
MAR 25 '2010

OFFICIAL BUSINESS
PENALTY FOR PRIVATE USE \$300

RECEIVED
BY AZ STATE OFFICE
2010 APR 15 P 2:24
PHOENIX, ARIZONA

3-26
✓✓

Dan Ware
370 N Winchester Rd
Apache Junction, Arizona 85219
AZ933 TS AMC364399

NIXIE 850 SE 1 78 04/14/10

RETURN TO SENDER
UNCLAIMED
UNABLE TO FORWARD

BC: 85004442700 *0114-00785-25-41

0511081401 5000
85004@4427

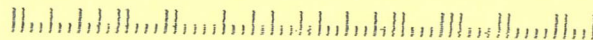

PLACE STICKER AT TOP OF ENVELOPE TO THE RIGHT
OF THE RETURN ADDRESS FOLD AT DOTTED LINE

SENDER: COMPLETE THIS SECTION

- Complete items 1, 2, and 3. Also complete item 4 if Restricted Delivery is desired.
- Print your name and address on the reverse so that we can return the card to you.
- Attach this card to the back of the mailpiece, or on the front if space permits.

1. Article Addressed to:

Dan Ware
 370 N Winchester Rd
 Apache Junction, Arizona 85219
 AZ933 TS AMC364399

2. Article Number
 (Transfer from service label)

7005 1160 0003 7539 7509

PS Form 3811, February 2004

COMPLETE THIS SECTION ON DELIVERY

A. Signature

X

Agent

Addressee

B. Received by (*Printed Name*)

C. Date of Delivery

D. Is delivery address different from item 1? Yes

If YES, enter delivery address below: No

3. Service Type

Certified Mail

Registered

Insured Mail

Express Mail

Return Receipt for Merchandise

C.O.D.

4. Restricted Delivery? (*Extra Fee*)

Yes

Domestic Return Receipt

102595-02-M-1540

SENDER: COMPLETE THIS SECTION

- Complete items 1, 2, and 3. Also complete item 4 if Restricted Delivery is desired.
- Print your name and address on the reverse so that we can return the card to you.
- Attach this card to the back of the mailpiece, or on the front if space permits.

1. Article Addressed to:

DEROCHER LEONARD
 5087 CRESTED SAGUARO LN
 GOLD CANYON, AZ 85218
 AZ933 TS AMC364399 031710

2. Article Number (Copy from service label)

7009 1410 0001 7124 4173

COMPLETE THIS SECTION ON DELIVERY

A. Received by (Please Print Clearly) B. Date of Delivery

LEONARDO A. DEROCHER 3-20-10

C. Signature

X  Agent
 Addressee

D. Is delivery address different from item 1? YesIf YES, enter delivery address below: No

3. Service Type

- Certified Mail Express Mail
 Registered Return Receipt for Merchandise
 Insured Mail C.O.D.

4. Restricted Delivery? (Extra Fee)

 Yes

UNITED STATES POSTAL SERVICE

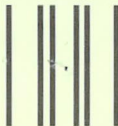

First-Class Mail
Postage & Fees Paid
USPS
Permit No. G-10

• Sender: Please print your name, address, and ZIP+4 in this box •

RECEIVED
BLM AZ STATE OFFICE

2010 SEP 2:00

PHOENIX, ARIZONA

U.S. DEPARTMENT OF THE INTERIOR
BUREAU OF LAND MANAGEMENT
ARIZONA STATE OFFICE
ONE NORTH CENTRAL AVE. SUITE 800
PHOENIX, ARIZONA 85004-4427

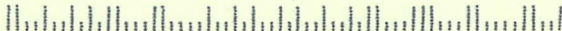

March 17, 2010

In Reply Refer To:
3800 (9330) TS
AMC364399

CERTIFIED MAIL - RETURN RECEIPT REQUESTED No. 7009 1410 0001 7124 4173

DECISION

DEROCHER LEONARD	:	This decision affects those claims shown
5087 CRESTED SAGUARO LN	:	in the block below:
GOLD CANYON, AZ 85218	:	

AMC364399
STANTON ROCKER 1

MINING CLAIMS
DECLARED FORFEITED

The mining claims listed above have been declared forfeited for failure to file the required maintenance fee payment or small miner's maintenance fee waiver (waiver).

Claimants are required to pay an annual non-refundable maintenance fee of \$140, or submit a waiver, on or before September 1 of each year. These requirements were established by 30 (United States Code) 28-f-k, as amended, and 43 Code of Federal Regulations (CFR) 3834 and 3835.

Our records do not show receipt of a maintenance fee payment, or waiver received on or before September 1, 2009, for the 2010 assessment year, for the claims listed above. Therefore, the claims are forfeited.

This decision does not relieve you of the liability for reclamation of all areas disturbed by your activities on lands covered by the subject mining claim(s) and/or site(s). After you complete the reclamation, you must notify the authorized officer of the appropriate surface managing agency so that the authorized officer may conduct a final site inspection and determine whether you may be released from liability.

If you fail to reclaim the land to the satisfaction of the authorized officer, the surface management agency may cite you for noncompliance under its surface management regulations.

For land administered by the Bureau of Land Management (BLM), if you fail to reclaim the land to the satisfaction of the authorized officer as required in 43 CFR Subpart 3809, BLM will issue an order of noncompliance under 43 CFR 3809.601(a). If you fail to comply with the noncompliance order, BLM may take further action under 43 CFR 3809.604. Failure to conduct reclamation is a prohibited act that may subject you to criminal penalties. See 43 CFR 3809.605(h) and 43 CFR 3809.700.

This decision may be appealed to the Interior Board of Land Appeals, Office of the Secretary, in accordance with the regulations contained in 43 CFR, Part 4, and the enclosed Form 1842-1. If an appeal is taken, your notice of appeal must be filed in this office (at the above address) within 30 days from receipt of this decision. The appellant has the burden of showing that the decision appealed from is in error.

If you wish to file a petition pursuant to regulation 43 CFR 4.21 (58 FR 4939, January 19, 1993) for a stay of the effectiveness of this decision during the time that your appeal is being reviewed by the Board, the petition for a stay must accompany your notice of appeal. A petition for a stay is required to show sufficient justification based on the standards listed below. Copies of the notice of appeal and petition for a stay **must** also be submitted to each party named in this decision and to the Interior Board of Land Appeals and to the appropriate Office of the Solicitor (see 43 CFR 4.413) at the same time the original documents are filed with this office. If you request a stay, you have the burden of proof to demonstrate that a stay should be granted.

Standards for Obtaining a Stay

Except as otherwise provided by law or other pertinent regulation, a petition for a stay of a decision pending appeal shall show sufficient justification based on the following standards:

- (1) The relative harm to the parties if the stay is granted or denied,
- (2) The likelihood of the appellant's success on the merits,
- (3) The likelihood of immediate and irreparable harm if the stay is not granted, and
- (4) Whether the public interest favors granting the stay.

Please include your AMC serial number(s) on all correspondence. If additional information is required, please call Tony Smith at 602-417-9355.

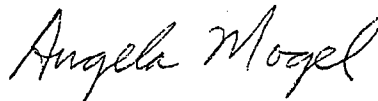

Angela Mogel
Acting Group Administrator
Renewable and Mineral Resources

Enclosure
Appeal Form 1842-1

TSmith:lm:031710

THIS ATTACHMENT INCLUDES THE NAMES AND ADDRESSES OF ALL CO-OWNERS OF THE MINING CLAIMS LISTED,
WHICH ARE DECLARED FORFEITED AND CLOSED.

LEAD FILE NUMBER	CLAIM NAME	CLAIM NUMBER	CLAIMANT NAME	ADDRESS	CITY	STATE	ZIP
AMC364399	STANTON ROCKER 1	AMC364399	GRIEGER JOSEPH R	7222 E JASMINE ST	MESA	AZ	85207
AMC364399	STANTON ROCKER 1	AMC364399	DEROCHER LEONARD	5087 CRESTED SAGUARO LN	GOLD CANYON	AZ	85218
AMC364399	STANTON ROCKER 1	AMC364399	WARE DAN	PO BOX 1200	APACHE JUNCTION	AZ	85217
AMC364399	STANTON ROCKER 1	AMC364399	MONTAGUE TED	4826 N VALLEY DR	APACHE JUNCTION	AZ	85120-8755

SENDER: COMPLETE THIS SECTION

- Complete items 1, 2, and 3. Also complete item 4 if Restricted Delivery is desired.
- Print your name and address on the reverse so that we can return the card to you.
- Attach this card to the back of the mailpiece, or on the front if space permits.

1. Article Addressed to:

MONTAGUE TED
 4826 N VALLEY DR
 APACHE JUNCTION, AZ 85120-8755
 AZ933 TS AMC364399 031710

2. Article Number (Copy from service label)

7009 1410 0001 7124 4197

COMPLETE THIS SECTION ON DELIVERY

A. Received by (Please Print Clearly) B. Date of Delivery

Raymond Plank

3-18-10

C. Signature

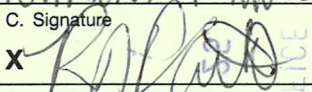
X 

-
- Agent
-
-
- Addressee

D. Is delivery address different from item 1?

 Yes

If YES, enter delivery address below:

 No

3. Service Type

-
- Certified Mail
-
- Express Mail
-
-
- Registered
-
- Return Receipt for Merchandise
-
-
- Insured Mail
-
- C.O.D.

4. Restricted Delivery? (Extra Fee)

 Yes

UNITED STATES POSTAL SERVICE



First-Class Mail
Postage & Fees Paid
USPS
Permit No. G-10

- Sender. Please print your name, address, and ZIP+4 in this box •

RECEIVED
BLM AZ STATE OFFICE

2011 SEP 13 1:25

PHOENIX ARIZONA

U.S. DEPARTMENT OF THE INTERIOR
BUREAU OF LAND MANAGEMENT
ARIZONA STATE OFFICE
ONE NORTH CENTRAL AVE. SUITE 800
PHOENIX, ARIZONA 85004-4427

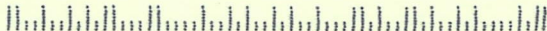

March 17, 2010

In Reply Refer To:
3800 (9330) TS
AMC364399

CERTIFIED MAIL - RETURN RECEIPT REQUESTED No. 7009 1410 0001 7124 4197

DECISION

MONTAGUE TED : This decision affects those claims shown
4826 N VALLEY DR : in the block below:
APACHE JUNCTION, AZ 85120-8755 :

AMC364399
STANTON ROCKER 1

MINING CLAIMS
DECLARED FORFEITED

The mining claims listed above have been declared forfeited for failure to file the required maintenance fee payment or small miner's maintenance fee waiver (waiver).

Claimants are required to pay an annual non-refundable maintenance fee of \$140, or submit a waiver, on or before September 1 of each year. These requirements were established by 30 (United States Code) 28-f-k, as amended, and 43 Code of Federal Regulations (CFR) 3834 and 3835.

Our records do not show receipt of a maintenance fee payment, or waiver received on or before September 1, 2009, for the 2010 assessment year, for the claims listed above. Therefore, the claims are forfeited.

This decision does not relieve you of the liability for reclamation of all areas disturbed by your activities on lands covered by the subject mining claim(s) and/or site(s). After you complete the reclamation, you must notify the authorized officer of the appropriate surface managing agency so that the authorized officer may conduct a final site inspection and determine whether you may be released from liability.

If you fail to reclaim the land to the satisfaction of the authorized officer, the surface management agency may cite you for noncompliance under its surface management regulations.

For land administered by the Bureau of Land Management (BLM), if you fail to reclaim the land to the satisfaction of the authorized officer as required in 43 CFR Subpart 3809, BLM will issue an order of noncompliance under 43 CFR 3809.601(a). If you fail to comply with the noncompliance order, BLM may take further action under 43 CFR 3809.604. Failure to conduct reclamation is a prohibited act that may subject you to criminal penalties. See 43 CFR 3809.605(h) and 43 CFR 3809.700.

This decision may be appealed to the Interior Board of Land Appeals, Office of the Secretary, in accordance with the regulations contained in 43 CFR, Part 4, and the enclosed Form 1842-1. If an appeal is taken, your notice of appeal must be filed in this office (at the above address) within 30 days from receipt of this decision. The appellant has the burden of showing that the decision appealed from is in error.

If you wish to file a petition pursuant to regulation 43 CFR 4.21 (58 FR 4939, January 19, 1993) for a stay of the effectiveness of this decision during the time that your appeal is being reviewed by the Board, the petition for a stay must accompany your notice of appeal. A petition for a stay is required to show sufficient justification based on the standards listed below. Copies of the notice of appeal and petition for a stay **must** also be submitted to each party named in this decision and to the Interior Board of Land Appeals and to the appropriate Office of the Solicitor (see 43 CFR 4.413) at the same time the original documents are filed with this office. If you request a stay, you have the burden of proof to demonstrate that a stay should be granted.

Standards for Obtaining a Stay

Except as otherwise provided by law or other pertinent regulation, a petition for a stay of a decision pending appeal shall show sufficient justification based on the following standards:

- (1) The relative harm to the parties if the stay is granted or denied,
- (2) The likelihood of the appellant's success on the merits,
- (3) The likelihood of immediate and irreparable harm if the stay is not granted, and
- (4) Whether the public interest favors granting the stay.

Please include your AMC serial number(s) on all correspondence. If additional information is required, please call Tony Smith at 602-417-9355.

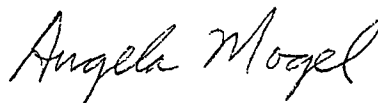

Angela Mogel
Acting Group Administrator
Renewable and Mineral Resources

Enclosure
Appeal Form 1842-1

TSmith:lm:031710

**THIS ATTACHMENT INCLUDES THE NAMES AND ADDRESSES OF ALL CO-OWNERS OF THE MINING CLAIMS LISTED,
WHICH ARE DECLARED FORFEITED AND CLOSED.**

LEAD FILE NUMBER	CLAIM NAME	CLAIM NUMBER	CLAIMANT NAME	ADDRESS	CITY	STATE	ZIP
AMC364399	STANTON ROCKER 1	AMC364399	GRIEGER JOSEPH R	7222 E JASMINE ST	MESA	AZ	85207
AMC364399	STANTON ROCKER 1	AMC364399	DEROCHER LEONARD	5087 CRESTED SAGUARO LN	GOLD CANYON	AZ	85218
AMC364399	STANTON ROCKER 1	AMC364399	WARE DAN	PO BOX 1200	APACHE JUNCTION	AZ	85217
AMC364399	STANTON ROCKER 1	AMC364399	MONTAGUE TED	4826 N VALLEY DR	APACHE JUNCTION	AZ	85120-8755

SENDER: COMPLETE THIS SECTION

- Complete items 1, 2, and 3. Also complete item 4 if Restricted Delivery is desired.
- Print your name and address on the reverse so that we can return the card to you.
- Attach this card to the back of the mailpiece, or on the front if space permits.

1. Article Addressed to:

GRIEGER JOSEPH R
 7222 E JASMINE ST
 MESA, AZ 85207
 AZ933 TS AMC364399 031710

2. Article

PS Form

COMPLETE THIS SECTION ON DELIVERY

A. Received by *(Please Print Clearly)* B. Date of Delivery

3/18/10

C. Signature

X *Joseph R Grieger*

- Agent
- Addressee

D. Is delivery address different from item 1?

If YES, enter delivery address below:

- Yes
- No

3. Service Type

- Certified Mail Express Mail
- Registered Return Receipt for Merchandise
- Insured Mail C.O.D.

4. Restricted Delivery? *(Extra Fee)*

- Yes

UNITED STATES POSTAL SERVICE

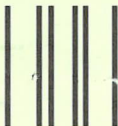

First-Class Mail
Postage & Fees Paid
USPS
Permit No. G-10

- Sender: Please print your name, address, and ZIP+4 in this box •

AZ
933

**U.S. DEPARTMENT OF THE INTERIOR
BUREAU OF LAND MANAGEMENT
ARIZONA STATE OFFICE
ONE NORTH CENTRAL AVE. SUITE 800
PHOENIX, ARIZONA 85004-4427**

PHOENIX, ARIZONA

2010 MAR 19 P 1:26

RECEIVED
BLM AZ STATE OFFICE

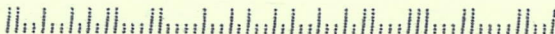

March 17, 2010

In Reply Refer To:
3800 (9330) TS
AMC364399

CERTIFIED MAIL - RETURN RECEIPT REQUESTED No. 7009 1410 0001 7124 4166

DECISION

GRIEGER JOSEPH R : This decision affects those claims shown
7222 E JASMINE ST : in the block below:
MESA, AZ 85207 :

AMC364399
STANTON ROCKER 1

MINING CLAIMS
DECLARED FORFEITED

The mining claims listed above have been declared forfeited for failure to file the required maintenance fee payment or small miner's maintenance fee waiver (waiver).

Claimants are required to pay an annual non-refundable maintenance fee of \$140, or submit a waiver, on or before September 1 of each year. These requirements were established by 30 (United States Code) 28-f-k, as amended, and 43 Code of Federal Regulations (CFR) 3834 and 3835.

Our records do not show receipt of a maintenance fee payment, or waiver received on or before September 1, 2009, for the 2010 assessment year, for the claims listed above. Therefore, the claims are forfeited.

This decision does not relieve you of the liability for reclamation of all areas disturbed by your activities on lands covered by the subject mining claim(s) and/or site(s). After you complete the reclamation, you must notify the authorized officer of the appropriate surface managing agency so that the authorized officer may conduct a final site inspection and determine whether you may be released from liability.

If you fail to reclaim the land to the satisfaction of the authorized officer, the surface management agency may cite you for noncompliance under its surface management regulations.

For land administered by the Bureau of Land Management (BLM), if you fail to reclaim the land to the satisfaction of the authorized officer as required in 43 CFR Subpart 3809, BLM will issue an order of noncompliance under 43 CFR 3809.601(a). If you fail to comply with the noncompliance order, BLM may take further action under 43 CFR 3809.604. Failure to conduct reclamation is a prohibited act that may subject you to criminal penalties. See 43 CFR 3809.605(h) and 43 CFR 3809.700.

This decision may be appealed to the Interior Board of Land Appeals, Office of the Secretary, in accordance with the regulations contained in 43 CFR, Part 4, and the enclosed Form 1842-1. If an appeal is taken, your notice of appeal must be filed in this office (at the above address) within 30 days from receipt of this decision. The appellant has the burden of showing that the decision appealed from is in error.

If you wish to file a petition pursuant to regulation 43 CFR 4.21 (58 FR 4939, January 19, 1993) for a stay of the effectiveness of this decision during the time that your appeal is being reviewed by the Board, the petition for a stay must accompany your notice of appeal. A petition for a stay is required to show sufficient justification based on the standards listed below. Copies of the notice of appeal and petition for a stay **must** also be submitted to each party named in this decision and to the Interior Board of Land Appeals and to the appropriate Office of the Solicitor (see 43 CFR 4.413) at the same time the original documents are filed with this office. If you request a stay, you have the burden of proof to demonstrate that a stay should be granted.

Standards for Obtaining a Stay

Except as otherwise provided by law or other pertinent regulation, a petition for a stay of a decision pending appeal shall show sufficient justification based on the following standards:

- (1) The relative harm to the parties if the stay is granted or denied,
- (2) The likelihood of the appellant's success on the merits,
- (3) The likelihood of immediate and irreparable harm if the stay is not granted, and
- (4) Whether the public interest favors granting the stay.

Please include your AMC serial number(s) on all correspondence. If additional information is required, please call Tony Smith at 602-417-9355.

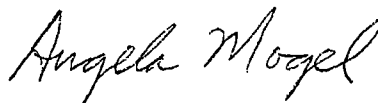

Angela Mogel
Acting Group Administrator
Renewable and Mineral Resources

Enclosure
Appeal Form 1842-1

TSmith:lm:031710

**THIS ATTACHMENT INCLUDES THE NAMES AND ADDRESSES OF ALL CO-OWNERS OF THE MINING CLAIMS LISTED,
WHICH ARE DECLARED FORFEITED AND CLOSED.**

LEAD FILE NUMBER	CLAIM NAME	CLAIM NUMBER	CLAIMANT NAME	ADDRESS	CITY	STATE	ZIP
AMC364399	STANTON ROCKER 1	AMC364399	GRIEGER JOSEPH R	7222 E JASMINE ST	MESA	AZ	85207
AMC364399	STANTON ROCKER 1	AMC364399	DEROCHER LEONARD	5087 CRESTED SAGUARO LN	GOLD CANYON	AZ	85218
AMC364399	STANTON ROCKER 1	AMC364399	WARE DAN	PO BOX 1200	APACHE JUNCTION	AZ	85217
AMC364399	STANTON ROCKER 1	AMC364399	MONTAGUE TED	4826 N VALLEY DR	APACHE JUNCTION	AZ	85120-8755



United States Department of the Interior



BUREAU OF LAND MANAGEMENT
Arizona State Office
One North Central Avenue, Suite 800
Phoenix, Arizona 85004-4427
www.blm.gov/az/

March 17, 2010

In Reply Refer To:
3800 (9330) TS
AMC364399

CERTIFIED MAIL - RETURN RECEIPT REQUESTED No. 7009 1410 0001 7124 4180

DECISION

WARE DAN : This decision affects those claims shown
370 N WINCHESTER RD : in the block below:
APACHE JUNCTION, AZ 85219 :

AMC364399
STANTON ROCKER 1

MINING CLAIMS DECLARED FORFEITED

The mining claims listed above have been declared forfeited for failure to file the required maintenance fee payment or small miner's maintenance fee waiver (waiver).

Claimants are required to pay an annual non-refundable maintenance fee of \$140, or submit a waiver, on or before September 1 of each year. These requirements were established by 30 (United States Code) 28-f-k, as amended, and 43 Code of Federal Regulations (CFR) 3834 and 3835.

Our records do not show receipt of a maintenance fee payment, or waiver received on or before September 1, 2009, for the 2010 assessment year, for the claims listed above. Therefore, the claims are forfeited.

This decision does not relieve you of the liability for reclamation of all areas disturbed by your activities on lands covered by the subject mining claim(s) and/or site(s). After you complete the reclamation, you must notify the authorized officer of the appropriate surface managing agency so that the authorized officer may conduct a final site inspection and determine whether you may be released from liability.

If you fail to reclaim the land to the satisfaction of the authorized officer, the surface management agency may cite you for noncompliance under its surface management regulations.

For land administered by the Bureau of Land Management (BLM), if you fail to reclaim the land to the satisfaction of the authorized officer as required in 43 CFR Subpart 3809, BLM will issue an order of noncompliance under 43 CFR 3809.601(a). If you fail to comply with the noncompliance order, BLM may take further action under 43 CFR 3809.604. Failure to conduct reclamation is a prohibited act that may subject you to criminal penalties. See 43 CFR 3809.605(h) and 43 CFR 3809.700.

This decision may be appealed to the Interior Board of Land Appeals, Office of the Secretary, in accordance with the regulations contained in 43 CFR, Part 4, and the enclosed Form 1842-1. If an appeal is taken, your notice of appeal must be filed in this office (at the above address) within 30 days from receipt of this decision. The appellant has the burden of showing that the decision appealed from is in error.

If you wish to file a petition pursuant to regulation 43 CFR 4.21 (58 FR 4939, January 19, 1993) for a stay of the effectiveness of this decision during the time that your appeal is being reviewed by the Board, the petition for a stay must accompany your notice of appeal. A petition for a stay is required to show sufficient justification based on the standards listed below. Copies of the notice of appeal and petition for a stay **must** also be submitted to each party named in this decision and to the Interior Board of Land Appeals and to the appropriate Office of the Solicitor (see 43 CFR 4.413) at the same time the original documents are filed with this office. If you request a stay, you have the burden of proof to demonstrate that a stay should be granted.

Standards for Obtaining a Stay

Except as otherwise provided by law or other pertinent regulation, a petition for a stay of a decision pending appeal shall show sufficient justification based on the following standards:

- (1) The relative harm to the parties if the stay is granted or denied,
- (2) The likelihood of the appellant's success on the merits,
- (3) The likelihood of immediate and irreparable harm if the stay is not granted, and
- (4) Whether the public interest favors granting the stay.

Please include your AMC serial number(s) on all correspondence. If additional information is required, please call Tony Smith at 602-417-9355.

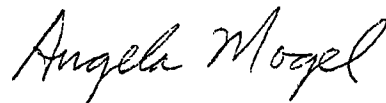

Angela Mogel
Acting Group Administrator
Renewable and Mineral Resources

Enclosure
Appeal Form 1842-1

THIS ATTACHMENT INCLUDES THE NAMES AND ADDRESSES OF ALL CO-OWNERS OF THE MINING CLAIMS LISTED,
WHICH ARE DECLARED FORFEITED AND CLOSED.

LEAD FILE NUMBER	CLAIM NAME	CLAIM NUMBER	CLAIMANT NAME	ADDRESS	CITY	STATE	ZIP
AMC364399	STANTON ROCKER 1	AMC364399	GRIEGER JOSEPH R	7222 E JASMINE ST	MESA	AZ	85207
AMC364399	STANTON ROCKER 1	AMC364399	DEROCHER LEONARD	5087 CRESTED SAGUARO LN	GOLD CANYON	AZ	85218
AMC364399	STANTON ROCKER 1	AMC364399	WARE DAN	PO BOX 1200	APACHE JUNCTION	AZ	85217
AMC364399	STANTON ROCKER 1	AMC364399	MONTAGUE TED	4826 N VALLEY DR	APACHE JUNCTION	AZ	85120-8755

CERTIFIED MAIL™

AN E

UNITED STATES
DEPARTMENT OF INTERIOR
Bureau of Land Management
Arizona State Office
One North Central Avenue, Suite 800
Phoenix, Arizona 85004-4427

OFFICIAL BUSINESS
PENALTY FOR PRIVATE USE \$300



7009 1410 0001 7124 4180



UNITED STATES POSTAGE
U.S. OFFICIAL MAIL
PENALTY FOR
PRIVATE USE \$300
PITNEY BOWES
02 1A
0004205804 MAR 18 2010
\$ 05.71⁰⁰
MAILED FROM ZIP CODE 85004

WARE DAN
370 N WINCHESTER RD
APACHE JUNCTION, AZ 85219
031710

3-19 ✓
3-23

NIXIE 850 5E 1 39 04/07/10

RETURN TO SENDER
UNCLAIMED
UNABLE TO FORWARD

BC: 85004442700 *1179-08135-18-40



000044427

370 04

AZ 933

RECEIVED
BLM AZ STATE OFFICE

2010 APR -8 A 11: 12

PHOENIX, ARIZONA

OF THE RETURN ADDRESS, FOLD AT DOTTED LINE
KEEPER AT TOP OF ENVELOPE TO THE RIGHT

SENDER: COMPLETE THIS SECTION

- Complete items 1, 2, and 3. Also complete item 4 if Restricted Delivery is desired.
- Print your name and address on the reverse so that we can return the card to you.
- Attach this card to the back of the mailpiece, or on the front if space permits.

1. Article Addressed to:

WARE DAN
 370 N WINCHESTER RD
 APACHE JUNCTION, AZ 85219
 AZ933 TS AMC364399 031710

2. Article Number (Copy from service label)

7009 1410 0001 7124 4180

COMPLETE THIS SECTION ON DELIVERY

A. Received by (Please Print Clearly) B. Date of Delivery

C. Signature Agent
 X Addressee

D. Is delivery address different from item 1? Yes
 If YES, enter delivery address below: No

3. Service Type
 Certified Mail Express Mail
 Registered Return Receipt for Merchandise
 Insured Mail C.O.D.

4. Restricted Delivery? (Extra Fee) Yes

NOTICE!!

These documents have been scanned!

Do not place un-scanned documents beneath this notice!

Do not remove this notice from this file!

GPO Jacket No. 560-102
Print Order 61540
Rise Business Services, LLC
Job=AZ15 6/26/2019



Box Number= AZ15131



Claim Begin-End: AMC364399-AMC364399

3 Transfers



AZ15131-12

AMC364221-AMC364399

**NO
DOCUMENTS
FOUND**

NO DOCUMENTS FOUND
NO DOCUMENTS FOUND

NOTICE!!

These documents have been scanned!

Do not place un-scanned documents beneath this notice!

Do not remove this notice from this file!

GPO Jacket No. 560-102
Print Order 61540
Rise Business Services, LLC
Job=AZ15 6/26/2019



Box Number= AZ15131



Claim Begin-End: AMC364399-AMC364399

4 Annual Filings



AZ15131-12

AMC364221-AMC364399

DEPARTMENT OF THE INTERIOR
BUREAU OF LAND MANAGEMENT
MINING CLAIMS

Run Date/Time: 9/5/2019

MC Maintenance Fees Paid Through the BLM Pay Portal
(by Date Paid)

Page 294 Of 521

CBS Receipt: 4548051

Printed For Lead File # AMC364399

Agency Tracking ID: 1567106148

Assessment Year: 2020

Number of BLM Serial Nr: 5

Paid On: 8/29/2019

Total Amount Paid: \$990.00

Claim Name	BLM Serial No	Lead File No	Amount Paid
M & M	AMC362401	AMC362401	\$165.00
B & B	AMC362442	AMC362442	\$165.00
RIO SECO	AMC362444	AMC362442	\$165.00
SOARING EAGLE 2	AMC362445	AMC362442	\$165.00
STANTON ROCKER 1	AMC364399	AMC364399	\$330.00

United States Department of the Interior
Bureau of Land Management
 BUSINESS & SUPPORT SVCS DIV
 ONE N CENTRAL AVE SUITE 800
 PHOENIX, AZ 85004 -4427
 Phone: 602-417-9200

Receipt

No: 4548051

Transaction #: 4669081	
Date of Transaction: 08/29/2019	
CUSTOMER:	
DAN WARE P.O. BOX 1200 APACHE JUNCTION, AZ 85117 US	

LINE #	QTY	DESCRIPTION	REMARKS	UNIT PRICE	TOTAL
1	1.00	LOCATABLE MINERALS / MINING CLAIMS- NOT NEW-UNADJUD, ONE AUTH NO. ONLY / MINING CLAIM MONEY RECEIVED CASES: AMC362401/\$990.00		- n/a -	990.00
TOTAL:					\$990.00

PAYMENT INFORMATION			
NOTE: Items will appear on credit card statement as "BLM O Mining Claim".			
1	AMOUNT:	990.00	POSTMARKED: N/A
	TYPE:	CREDIT CARD	RECEIVED: 08/29/2019
	NAME:	DAN WARE P.O. BOX 1200 APACHE JUNCTION AZ 85117 US	
	CARD NO:	XXXXXXXXXXXX6483	AUTH CODE: 171479
	NAME ON CARD:	DAN WARE	
	SIGNATURE:	INTERNET	

REMARKS

This receipt was generated by the automated BLM Collections and Billing System and is a paper representation of a portion of the official electronic record contained therein.

DEPARTMENT OF THE INTERIOR
BUREAU OF LAND MANAGEMENT
MINING CLAIMS



Run Date/Time: 9/11/2018

MC Maintenance Fees Paid Through the BLM Pay Portal
(by Date Paid)

Page 566 Of 723

CBS Receipt: 4250988

Printed For Lead File # AMC364399

Agency Tracking ID: 1535653638

Assessment Year: 2019

Paid On: 8/30/2018

Number of BLM Serial Nr: 5

Total Amount Paid: \$930.00

Claim Name	BLM Serial No	Lead File No	Amount Paid
M & M	AMC362401	AMC362401	\$155.00
B & B	AMC362442	AMC362442	\$155.00
RIO SECO	AMC362444	AMC362442	\$155.00
SOARING EAGLE 2	AMC362445	AMC362442	\$155.00
STANTON ROCKER 1	AMC364399	AMC364399	\$310.00

United States Department of the Interior
Bureau of Land Management
 BUSINESS & SUPPORT SVCS DIV
 ONE N CENTRAL AVE SUITE 800
 PHOENIX, AZ 85004 -4427
 Phone: 602-417-9200

Receipt

No: 4250988

Transaction #: 4366496	
Date of Transaction: 08/30/2018	
CUSTOMER:	
DAN R WARE 370 N. WINCHESTER RD. APACHE JUNCTION, AZ 85119 US	

LINE #	QTY	DESCRIPTION	REMARKS	UNIT PRICE	TOTAL
1	1.00	LOCATABLE MINERALS / MINING CLAIMS-NOT NEW-UNADJUD, ONE AUTH NO. ONLY / MINING CLAIM MONEY RECEIVED CASES: AMC362401/\$930.00		- n/a -	930.00
TOTAL:					\$930.00

PAYMENT INFORMATION			
NOTE: Items will appear on credit card statement as "BLM O Mining Claim".			
1	AMOUNT:	930.00	POSTMARKED: N/A
	TYPE:	CREDIT CARD	RECEIVED: 08/30/2018
	NAME:	DAN R WARE 370 N. WINCHESTER RD. APACHE JUNCTION AZ 85119 US	
	CARD NO:	XXXXXXXXXXXX1338	AUTH CODE: 05118C
	NAME ON CARD:	DAN R WARE	
	SIGNATURE:		

REMARKS

This receipt was generated by the automated BLM Collections and Billing System and is a paper representation of a portion of the official electronic record contained therein.

Run Date: 08/28/17

Run Time: 12:44 PM

**DEPARTMENT OF THE INTERIOR
BUREAU OF LAND MANAGEMENT
MINING CLAIMS**

MC Maintenance Fees Paid Through the BLM Pay Portal

CBS Receipt: 3951255

Printed For Lead File # AMC364399

Agency Tracking ID: 1503429948

Assessment Year: 2018

Number of BLM Serial Nr: 5

Paid On: 08/22/2017

Total Amount Paid: \$930.00

Claim Name	BLM Serial No	Lead File No	Amount Paid
M & M	AMC362401	AMC362401	\$155.00
B & B	AMC362442	AMC362442	\$155.00
RIO SECO	AMC362444	AMC362442	\$155.00
SOARING EAGLE 2	AMC362445	AMC362442	\$155.00
STANTON ROCKER 1	AMC364399	AMC364399	\$310.00

United States Department of the Interior
Bureau of Land Management
 BUSINESS & SUPPORT SVCS DIV
 ONE N CENTRAL AVE SUITE 800
 PHOENIX, AZ 85004 -4427
 Phone: 602-417-9200

Receipt

No: 3951255

Transaction #: 4060984	
Date of Transaction: 08/22/2017	
CUSTOMER:	
DAN WARE 2204 W. APACHE TRAIL APACHE JUNCTION, AZ 85120 US	

LINE #	QTY	DESCRIPTION	REMARKS	UNIT PRICE	TOTAL
1	1.00	LOCATABLE MINERALS / MINING CLAIMS- NOT NEW-UNADJUD, ONE AUTH NO. ONLY / MINING CLAIM MONEY RECEIVED CASES: AMC362444/\$930.00		- n/a -	930.00
TOTAL:					\$930.00

PAYMENT INFORMATION				
NOTE: Items will appear on credit card statement as "BLM O Mining Claim".				
1	AMOUNT:	930.00	POSTMARKED:	N/A
	TYPE:	CREDIT CARD	RECEIVED:	08/22/2017
	NAME:	DAN WARE 2204 W. APACHE TRAIL APACHE JUNCTION AZ 85120 US		
	CARD NO:	XXXXXXXXXXXX6483	AUTH CODE:	172998
	NAME ON CARD:	DAN WARE		
	EXPIRES:	03/2021		
	SIGNATURE:			

REMARKS

This receipt was generated by the automated BLM Collections and Billing System and is a paper representation of a portion of the official electronic record contained therein.

Run Date: 09/14/16

Run Time: 01:48 PM

**DEPARTMENT OF THE INTERIOR
BUREAU OF LAND MANAGEMENT
MINING CLAIMS**

MC Maintenance Fees Paid Through the BLM Pay Portal

CBS Receipt: 3647410

Printed For Lead File # AMC364399

Agency Tracking ID: 1472579638

Assessment Year: 2017

Number of BLM Serial Nr: 4

Paid On: 08/30/2016

Total Amount Paid: \$775.00

Claim Name	BLM Serial No	Lead File No	Amount Paid
B & B	AMC362442	AMC362442	\$155.00
RIO SECO	AMC362444	AMC362442	\$155.00
SOARING EAGLE 2	AMC362445	AMC362442	\$155.00
STANTON ROCKER 1	AMC364399	AMC364399	\$310.00

United States Department of the Interior
Bureau of Land Management
 BUSINESS & SUPPORT SVCS DIV
 ONE N CENTRAL AVE SUITE 800
 PHOENIX, AZ 85004 -4427
 Phone: (602) 417-9200

Receipt

No: 3647410

Transaction #: 3751397	
Date of Transaction: 08/30/2016	
CUSTOMER:	
SUPERSTITION MOUNTAIN 2204 W APACHE TRAIL APACHE JUNCTION, AZ 85120 US	

LINE #	QTY	DESCRIPTION	REMARKS	UNIT PRICE	TOTAL
1	1.00	LOCATABLE MINERALS / MINING CLAIMS- NOT NEW-UNADJUD, ONE AUTH NO. ONLY / MINING CLAIM MONEY RECEIVED CASES: AMC362444/\$775.00		- n/a -	775.00
TOTAL:					\$775.00

PAYMENT INFORMATION			
NOTE: Items will appear on credit card statement as "BLM O Mining Claim".			
1	AMOUNT:	775.00	POSTMARKED: N/A
	TYPE:	CREDIT CARD	RECEIVED: 08/30/2016
	NAME:	SUPERSTITION MOUNTAIN 2204 W APACHE TRAIL APACHE JUNCTION AZ 85120 US	
	CARD NO:	XXXXXXXXXXXX6483	AUTH CODE: 135668
	NAME ON CARD:	SUPERSTITION MOUNTAIN	
	EXPIRES:	09/2017	
	SIGNATURE:		

REMARKS

This receipt was generated by the automated BLM Collections and Billing System and is a paper representation of a portion of the official electronic record contained therein.

Run Date: 09/08/15

Run Time: 09:20 AM

**DEPARTMENT OF THE INTERIOR
BUREAU OF LAND MANAGEMENT
MINING CLAIMS**

MC Maintenance Fees Paid Through the BLM Pay Portal

CBS Receipt: 3377921

Printed For Lead File # AMC364399

Agency Tracking ID: 1440619003

Assessment Year: 2016

Number of BLM Serial Nr: 5

Paid On: 08/26/2015

Total Amount Paid: \$930.00

Claim Name	BLM Serial No	Lead File No	Amount Paid
M & M	AMC362401	AMC362401	\$155.00
B & B	AMC362442	AMC362442	\$155.00
RIO SECO	AMC362444	AMC362442	\$155.00
SOARING EAGLE 2	AMC362445	AMC362442	\$155.00
STANTON ROCKER 1	AMC364399	AMC364399	\$310.00

United States Department of the Interior
Bureau of Land Management
 BUSINESS & SUPPORT SVCS DIV
 ONE N CENTRAL AVE SUITE 800
 PHOENIX, AZ 85004 -4427
 Phone: (602) 417-9200

Receipt

No: 3377921

Transaction #: 3476173	
Date of Transaction: 08/26/2015	
CUSTOMER:	
DAN WARE PO. BOX1200 APACHE JUNCTION,AZ 85117 US	

LINE #	QTY	DESCRIPTION	REMARKS	UNIT PRICE	TOTAL
1	1.00	LOCATABLE MINERALS / MINING CLAIMS- NOT NEW-UNADJUD,ONE AUTH NO. ONLY / MINING CLAIM MONEY RECEIVED CASES: AMC364399/\$930.00		- n/a -	930.00
TOTAL:					\$930.00

PAYMENT INFORMATION			
NOTE: Items will appear on credit card statement as "BLM O Mining Claim".			
1	AMOUNT:	930.00	POSTMARKED: N/A
	TYPE:	CREDIT CARD	RECEIVED: 08/26/2015
	NAME:	DAN WARE PO. BOX1200 APACHE JUNCTION AZ 85117 US	
	CARD NO:	XXXXXXXXXXXX6483	AUTH CODE: 175291
	NAME ON CARD:	DAN WARE	
	EXPIRES:	09/2017	
	SIGNATURE:		

REMARKS

This receipt was generated by the automated BLM Collections and Billing System and is a paper representation of a portion of the official electronic record contained therein.

Run Date: 08/20/14

45

Run Time: 03:40 PM

362401
362442
364399

**DEPARTMENT OF THE INTERIOR
BUREAU OF LAND MANAGEMENT
MINING CLAIMS**

MC Maintenance Fees Paid Through the BLM Pay Portal

CBS Receipt: 3105089

Agency Tracking ID: 627050568

Assessment Year: 2015

Paid On : 08/18/2014

Number of BLM Serial Nr: 5

Total Amount Paid: \$930.00

Claim Name	BLM Serial No	Lead File No	Case Type	Amount Paid
M & M	AMC362401	AMC362401	384201	\$155.00
B & B	AMC362442	AMC362442		\$155.00
RIO SECO	AMC362444			\$155.00
SOARING EAGLE 2	AMC362445			\$155.00
STANTON ROCKER 1	AMC364399	AMC364399		\$310.00

United States Department of the Interior
Bureau of Land Management
 BUSINESS & SUPPORT SVCS DIV
 ONE N CENTRAL AVE SUITE 800
 PHOENIX, AZ 85004 -4427
 Phone: (602) 417-9200

Receipt

No: 3105089

Transaction #: 3196696	
Date of Transaction: 08/18/2014	
CUSTOMER:	
	DAN WARE P.O. BOX 1200 APACHE JUNCTION, AZ 85117

LINE #	QTY	DESCRIPTION	REMARKS	UNIT PRICE	TOTAL
1	1.00	LOCATABLE MINERALS / MINING CLAIMS- NOT NEW-UNADJUD, ONE AUTH NO. ONLY / MINING CLAIM MONEY RECEIVED CASES: AMC362444/\$930.00		- n/a -	930.00
TOTAL:					\$930.00

PAYMENT INFORMATION			
NOTE: Items will appear on credit card statement as "BLM O Mining Claim".			
1	AMOUNT:	930.00	POSTMARKED: N/A
	TYPE:	CREDIT CARD	RECEIVED: 08/18/2014
	NAME:	DAN WARE P.O. BOX 1200 APACHE JUNCTION AZ 85117	
	CARD NO:	XXXXXXXXXXXX6483	AUTH CODE: 191365
	NAME ON CARD:	DAN WARE	
	EXPIRES:	09/2017	
	SIGNATURE:		

REMARKS

This receipt was generated by the automated BLM Collections and Billing System and is a paper representation of a portion of the official electronic record contained therein.

UNITED STATES
DEPARTMENT OF THE INTERIOR
BUREAU OF LAND MANAGEMENT
**MAINTENANCE FEE PAYMENT FORM FOR
LODE CLAIMS, MILL SITES, AND TUNNEL SITES**

362401
362442
364399

Remitter Name: Dan Ware
Mailing Address: P.O. Box 1200
City, State, Zip: Apache Junction, Az. 85217

Check here if this is a change of address.

FOR COUNTY RECORDER'S USE

Paid check # 1437

No. of claims/sites 6 (5 + 1 at 40 acres)
x \$140 per claim/site
Total due BLM \$ 840⁰⁰

- The maintenance fee may be paid by cash, check, money order, Bureau of Land Management (BLM) Declining Deposit Account, or credit card (VISA, American Express, Discover, or MasterCard). Payments must be remitted to the BLM State Office where your claim or site is recorded and received on or before September 1. If the payment is mailed, the envelope must be postmarked by a bona fide delivery service on or before September 1 and received at the proper BLM State Office within 15 calendar days after the due date. Payments may also be made by telephone using a credit card. A complete listing of BLM State Offices with their addresses and phone numbers can be found at <http://www.blm.gov>.
- The maintenance fee for the following claim(s)/site(s) applies to the assessment year _____.

CLAIM/SITE NAME	BLM SERIAL NO.	
Rio Seco	20 acres AMC - 362444	140 ⁰⁰
B+B	20 acres AMC - 362442	140 ⁰⁰
m+m	20 acres AMC - 362401	140 ⁰⁰
Soaring Eagle II	20 acres AMC - 362445	140 ⁰⁰
Stanton Rocker 1	40 acres AMC - 364399	280 ⁰⁰

RECEIVED
BLM AZ STATE OFFICE
2013 AUG 28 P 4:44
PHOENIX, ARIZONA

Use a separate sheet for additional claim/site names, serial numbers, and claimant names and addresses.

(Continued on page 2)

ENTERED
SEP - 6 2013
BY: RE

Receipt # 268
2868294
MAA

CERTIFIED MAIL™



P.O. Box 1200
Apache Junction, AZ 85217



7012 1640 0000 1509 4905



UNITED STATES
POSTAL SERVICE

1000



PHOENIX, ARIZONA

AUG 28 P 1:44

U.S. POSTAGE
PAID
APACHE JUNCTION, AZ
85120
AUG 27, 13
AMOUNT

BLM AZ STATE OFFICE

\$6.11

00029886-02

RETURN RECEIPT
REQUESTED

Bureau of Land Management
Arizona State office
1 North Central Ave, Suite 800
Phoenix, Arizona 85004

85004\$4427

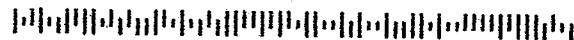

**United States Department of the Interior
Bureau of Land Management
LANDS/RECREATION & PLANNING
ONE N CENTRAL AVE
PHOENIX, AZ 85004 -2203
Phone: 602-417-9200**

Receipt

No: 2868294

Transaction #: 2954252	
Date of Transaction: 08/29/2013	
CUSTOMER:	
DAN WARE PO BOX 1200 APACHE JUNCTION, AZ 85217-1200 US	

LINE #	QTY	DESCRIPTION	REMARKS	UNIT PRICE	TOTAL
1	1.00	LOCATABLE MINERALS / MINING CLAIMS- NOT NEW-UNADJUD, ONE AUTH NO. ONLY / MINING CLAIM MONEY RECEIVED CASES: AMC362444/\$840.00	MAINT FEE PYMNT (6) 2014	- n/a -	840.00
TOTAL:					\$840.00

PAYMENT INFORMATION					
1	AMOUNT:	840.00	POSTMARKED:	08/27/2013	
	TYPE:	CHECK	RECEIVED:	08/28/2013	
	CHECK NO:	1437			
	NAME:	SUPERSTITION MOUNTAIN TREASURE HUNTERS INC 940 W APACHE TRAIL APACHE JUNCTION AZ 85120 US			

REMARKS

This receipt was generated by the automated BLM Collections and Billing System and is a paper representation of a portion of the official electronic record contained therein.

Amc 362401
 Amc 364399
 Amc 362705
 Amc 362442
 RECEIVED
 BLM AZ STATE OFFICE
 2012 AUG 29 P 3:00
 PHOENIX, ARIZONA

MAINTENANCE FEE PAYMENT

Claimant Name: Dan Ware
 Address: P.O. Box 1200
 City: Apache Jet. State: Az Zip: 85217
 Telephone: 480-720-7486
 E-mail address: _____
 Signature: Dan Ware
 Check here if this is a change of address.

RECEIVED
 BLM AZ STATE OFFICE
 2011 AUG 22 A 7:50
 PHOENIX, ARIZONA
 BLM Date Stamp

LINE NO.	AMC NUMBER	CLAIM/SITE NAME	COUNTY RECORDER DATA (If available)	TWP	RNG	SEC
1	362705	Desert Rose 1	2006-0510015	2S	6W	19/20
2	362445	Soaring Eagle 2		12N	2W	12/13
3	362401	Midget Mim		9N	10E	5/6-7
4	362442	B+B	2003-015410	9N	10E	7/8-18
5	362444	Rio Seco	2006-058036	2S	15E	5/8-9
6	364399	Stanton Rocker 1	2005-3835835	9N	4W	18
7						
8						
9						
10						

Reling
 80
 80
 80
 140
 40 X

List additional claims on Form MCF114.

Bureau of Land Management
 Arizona State Office
 www.blm.gov/az/

No. of Claims: 6 x \$140 = 840.00
 Check No: 1358 Init: SWB
 Receipt No.: 2410807
 For BLM Use Only

Form: MCF112
 Revised July 2009

This form is available from the Arizona Department of Mines and Mineral Resources and may be reproduced.

#4340-840 = #3,500 due
 Reling. Amc 362705 refunded \$140
 pd #140 addl Amc 364399

NO. OF CLAIMS 6
 AMOUNT \$840.00
 RECEIPT NO. 2644837
 NIT. CAH

ENTERED INTO COMPUTER
 9/11/12 AT

Dan Ware
P.O. Box 1200
Apache Jct. Az. 85217

RECEIVED
BLM AZ STATE OFFICE

2012 AUG 29 P 3:00

PHOENIX, ARIZONA
Bureau of Land Management

One N. Central Ave

Phoenix, Az. 85004-2203

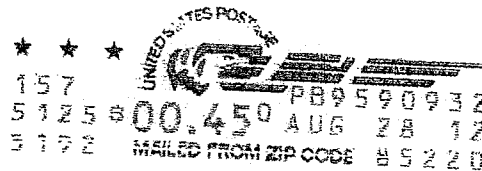

8500434414

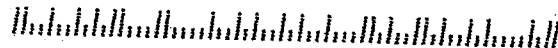

United States Department of the Interior
Bureau of Land Management
 LANDS/RECREATION & PLANNING
 ONE N CENTRAL AVE
 PHOENIX, AZ 85004 -2203
 Phone: 602-417-9200

Receipt

No: 2644837

Transaction #: 2725598	
Date of Transaction: 08/30/2012	
CUSTOMER:	
DAN WARE PO BOX 1200 APACHE JUNCTION, AZ 85117-4048 US	

LINE #	QTY	DESCRIPTION	REMARKS	UNIT PRICE	TOTAL
1	1.00	LOCATABLE MINERALS / MINING CLAIMS-NOT NEW-UNADJUD, ONE AUTH NO. ONLY / MINING CLAIM MONEY RECEIVED CASES: AMC362705/\$840.00	MAINT FEE PYMNT (6) 2013	- n/a -	840.00
TOTAL:					\$840.00

PAYMENT INFORMATION			
1	AMOUNT:	840.00	POSTMARKED: N/A
	TYPE:	CHECK	RECEIVED: 08/29/2012
	CHECK NO:	1395	
	NAME:	SUPERSTITION MOUNTAIN TREASURE HUNTERS INC 940 W APACHE TRAIL APACHE JUNCTION AZ 85120 US	

REMARKS

This receipt was generated by the automated BLM Collections and Billing System and is a paper representation of a portion of the official electronic record contained therein.

*Refunded \$140 for
 AMC 362705 - Relinquished
 4/26/13 AT*

Authorized Date04/24/2013

Instructions to AccountsAZ BLM REFUND \$140 TO SUPERSTITION MOUNTAIN TREASURE
HUNTERS INC FOR INSUFFICIENT 2013 MAINTENANCE FEES PAID
ON AMC362705 RECEIPT #2644837 AT

Login ID2393

Entry Date04/24/2013

Total Amount\$140.00

362442
 3624101
 362393
 362705

MAINTENANCE FEE PAYMENT

Claimant Name: Dan Ware
 Address: P.O. Box 1200
 City: Apache Jet. State: Az Zip: 85217
 Telephone: 480-720-7486
 E-mail address: _____
 Signature: Dan Ware

Check here if this is a change of address.

RECEIVED
 BLM AZ STATE OFFICE
 PHOENIX, ARIZONA
 2011 AUG 22 A 7:50
 BLM
 Date
 Stamp

LINE NO.	AMC NUMBER	CLAIM/SITE NAME	COUNTY RECORDER DATA (If available)	TWP	RNG	SEC
1	362705	Desert Rose 1	2006-0510015	2S	6W	19/20
2	362445	Soaring Eagle 2		12N	2W	12/13
3	362401	Midget		9N	10E	5/6-7
4	362442	B+B	2003-015410	9N	10E	7/8-18
5	362444	Rio Seco	2006-058036	2S	15E	5/8-9
6	364399	Stanton Rocker 1		9N	4W	18
7						
8						
9						
10						

ENTERED INTO COMPUTER
 SEP 03 2011

List additional claims on Form MCF114.

No. of Claims: 6 x \$140 = 840.00
 Check No: 1358 Init. SPB
 Receipt No.: 2410807
 For BLM Use Only

Bureau of Land Management
 Arizona State Office
 www.blm.gov/az/

United States Department of the Interior
 Bureau of Land Management
 LANDS/RECREATION & PLANNING
 ONE N CENTRAL AVE
 PHOENIX, AZ 85004 -2203
 Phone: 602-417-9200

Receipt

No: 2410807

Transaction #: 2486144	
Date of Transaction: 08/22/2011	
CUSTOMER:	
DAN WARE PO BOX 1200 APACHE JUNCTION, AZ 85217-1200 US	SEP 02 2011

LINE #	QTY	DESCRIPTION	REMARKS	UNIT PRICE	TOTAL
1	1.00	LOCATABLE MINERALS / MINING CLAIMS-NOT NEW-UNADJUD, ONE AUTH NO. ONLY / MINING CLAIM MONEY RECEIVED CASES: AMC362705/\$840.00	MAINT-6	- n/a -	840.00
TOTAL:					\$840.00

PAYMENT INFORMATION			
1	AMOUNT:	840.00	POSTMARKED: 08/17/2011
	TYPE:	CHECK	RECEIVED: 08/22/2011
	CHECK NO:	1358	
	NAME:	SUPERSTITION MOUNTAIN TREASURE HUNTERS INC 940 W APACHE TRAIL APACHE JUNCTION AZ 85120-5408 US	

REMARKS

This receipt was generated by the automated BLM Collections and Billing System and is a paper representation of a portion of the official electronic record contained therein.

Dan Ware
P.O. Box 1200
Apache Jct., Az. 85117

RECEIVED
POST OFFICE
AUG 19 3 15
PHOENIX, ARIZONA

UNITED STATES POSTAGE
129
5175 # 00.44⁰ PB9590932
0927 MAILED FROM ZIP CODE 85220
AUG 17 11

Bureau of Land Management
One North Central Ave. Suite 800
Phoenix, Az. 85004

8500484427

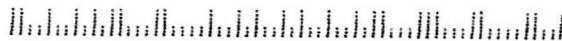

AMC 362705
 AMC 362442
 AMC 362401
 AMC 364399

MAINTENANCE FEE PAYMENT

Claimant Name: Don Ware
 Address: P.O. Box 1200
 City: Apache Jct. State: Az Zip: 85117
 Telephone: 780-720-7489
 E-mail address: _____
 Signature: Don Ware

Check here if this is a change of address.

RECEIVED
 BLM
 AZ STATE OFFICE
 2010 AUG - 3 A 7:52
 PHOENIX, ARIZONA
 BLM
 Date
 Stamp

LINE NO.	AMC NUMBER	CLAIM/SITE NAME	COUNTY RECORDER DATA (If available)	TWP	RNG	SEC	
1	362705	Desert Rose #I	2006-0510015	2 S	6 W	19/20	
2	362445	Soaring Eagle #II		12 N	2 W	12/13	
3	362401	Midget Mining		9 N	10 E	5/6/7	
4	362442	B & B	2003-015410	9 N	10 E	7/8/18	
5	362444	Rio Seco	2006-058036	5 S	15 E	5/8/19	
6	364399	Stanton Rucker #1		9 N	4 W	18	
7							
8		ENTERED INTO COMPUTER					
9			AUG 27 2010				
10							

List additional claims on Form MCF114.

Bureau of Land Management
 Arizona State Office
 www.blm.gov/az/

No. of Claims: 6 x \$140 = 840.00
 Check No: _____ Init: SW
 Receipt No.: 2183468
 For BLM Use Only

Form: MCF112
 Revised July 2009

This form is available from the Arizona Department of Mines and Mineral Resources and may be reproduced.

The address for the claimant needs to be updated for the highlighted claims.

United States Department of the Interior
 Bureau of Land Management
 LANDS/RECREATION & PLANNING
 ONE N CENTRAL AVE
 PHOENIX, AZ 85004 -2203
 Phone:

Receipt

No: 2183468

Transaction #: 2253101		ENTERED INTO COMPUTER
Date of Transaction: 08/04/2010		
CUSTOMER:	DAN WARE PO BOX 1200 APACHE JUNCTION, AZ 85217-1200 US	AUG 27 2010

LINE #	QTY	DESCRIPTION	REMARKS	UNIT PRICE	TOTAL
1	1.00	LOCATABLE MINERALS / MINING CLAIMS-NOT NEW-UNADJUD, ONE AUTH NO. ONLY / MINING CLAIM MONEY RECEIVED CASES: AMC362705/\$840.00	MAINT-6	- n/a -	840.00 ✓
TOTAL:					\$840.00

PAYMENT INFORMATION					
1	AMOUNT:	840.00	POSTMARKED:	07/27/2010	
	TYPE:	CHECK	RECEIVED:	08/03/2010	
	CHECK NO:	1299			
	NAME:	SUPERSTITION MOUNTIAN TREASURE HUNTERS INC 2204 W APACHE TRAIL APACHE JUNCTION AZ 85217-1200 US			

REMARKS

This receipt was generated by the automated BLM Collections and Billing System and is a paper representation of a portion of the official electronic record contained therein.

List of Proprietors

WARE DAN[2221719], 370 N WINCHESTER RD, , APACHE JUNCTION, AZ, 851191434, P, MATCHED ✓
WARE DAN[2272331], 940 W APACHE TRL, , APACHE JUNCTION, AZ, 851205408, P, MATCHED ✓

Select

Cancel

Customer Name Update Screen

System ID:MC

Name: WARE DAN

Lookup

Proprietor #: 2221719

Renumber To:

Category: P - PRIVATE

Address: PO BOX 1200

Address Updated
ENTERED INTO COMPUTER

City: APACHE JUNCTION

State: AZ

Zip: 851174048

SEP 24 2010 *ps*

Save

Save/Override DataFlux

Delete

Renumber

Customer details successfully saved for Customer Id 2221719

Customer Name Update Screen

System ID:MC

Name: WARE DAN

Proprietor #: 2221719

Category: P - PRIVATE

Address: 370 N WINCHESTER RD

City: APACHE JUNCTION

State: AZ

Zip: 851191434

Lookup

Renumber To:

← Previous Address

Save

Save/Override DataFlux

Delete

Renumber

AMC 362705
 AMC 362442
 AMC 362401
 AMC 364399

MAINTENANCE FEE PAYMENT

Claimant Name: Don Ware
 Address: P.O. Box 1200
 City: Apache Jct. State: Az Zip: 85117
 Telephone: 780-720-7489
 E-mail address: _____
 Signature: Don Ware

Check here if this is a change of address.

RECEIVED
 BLM AZ STATE OFFICE
 2010 AUG - 3 A 7:52
 PHOENIX, ARIZONA
 BLM
 Date
 Stamp

LINE NO.	AMC NUMBER	CLAIM/SITE NAME	COUNTY RECORDER DATA (If available)	TWP	RNG	SEC
1	362705	Desert Rose #I	2006-0510015	2 S	6 W	19/20
2	362445	Soaring Eagle #II		12 N	2 W	17/13
3	362401	Midget Mining		9 N	10 E	5/6/7
4	362442	B & B	2003-015410	9 N	10 E	7/8/18
5	362444	Rio Seco	2006-058036	5 S	15 E	5/8/19
6	364399	Stanton Rucker #1		9 N	4 W	18
7						
8			ENTERED INTO COMPUTER			
9			AUG 27 2010			
10						

List additional claims on Form MCF114.

Bureau of Land Management
 Arizona State Office
 www.blm.gov/az/

No. of Claims: 6 x \$140 = 840.00
 Check No: _____ Init. SW
 Receipt No.: 218.3468
 For BLM Use Only

Form: MCF112
 Revised July 2009

The address for the claimant needs to be updated for the highlighted claims.

United States Department of the Interior
 Bureau of Land Management
 LANDS/RECREATION & PLANNING
 ONE N CENTRAL AVE
 PHOENIX, AZ 85004 -2203
 Phone:

Receipt

No: 2183468

Transaction #: 2253101		ENTERED INTO COMPUTER
Date of Transaction: 08/04/2010		
CUSTOMER:	DAN WARE PO BOX 1200 ✓ APACHE JUNCTION, AZ 85217-1200 US	AUG 27 2010

LINE #	QTY	DESCRIPTION	REMARKS	UNIT PRICE	TOTAL
1	1.00	LOCATABLE MINERALS / MINING CLAIMS-NOT NEW-UNADJUD, ONE AUTH NO. ONLY / MINING CLAIM MONEY RECEIVED CASES: AMC362705/\$840.00	MAINT-6	- n/a -	840.00 ✓
TOTAL:					\$840.00

PAYMENT INFORMATION					
1	AMOUNT:	840.00	POSTMARKED:	07/27/2010	
	TYPE:	CHECK	RECEIVED:	08/03/2010	
	CHECK NO:	1299			
	NAME:	SUPERSTITION MOUNTIAN TREASURE HUNTERS INC 2204 W APACHE TRAIL APACHE JUNCTION AZ 85217-1200 US			

REMARKS

This receipt was generated by the automated BLM Collections and Billing System and is a paper representation of a portion of the official electronic record contained therein.

List of Proprietors

WARE DAN[2221719], 370 N WINCHESTER RD, , APACHE JUNCTION, AZ, 851191434, P, MATCHED ✓
WARE DAN[2272331], 940 W APACHE TRL, , APACHE JUNCTION, AZ, 851205408, P, MATCHED ✓

Select

Cancel

Customer Name Update Screen

System ID:MC

Name: WARE DAN

Lookup

Proprietor #: 2221719

Renumber To:

Category: P - PRIVATE

Address: PO BOX 1200

Address Updated
ENTERED INTO COMPUTER

City: APACHE JUNCTION

SEP 24 2010 *PK*

State: AZ

Zip: 851174048

Save

Save/Override DataFlux

Delete

Renumber

Customer details successfully saved for Customer Id 2221719

Customer Name Update Screen

System ID:MC

Name: WARE DAN

Lookup

Proprietor #: 2221719

Renumber To:

Category: P - PRIVATE

Address: 370 N WINCHESTER RD

← Previous Address

City: APACHE JUNCTION

State: AZ

Zip: 851191434

Save

Save/Override DataFlux

Delete

Renumber

United States Department of the Interior

Bureau of Land Management
 BUSINESS & SUPPORT SVCS DIV
 ONE N CENTRAL AVE SUITE 800
 PHOENIX, AZ 85004 -4427
 Phone: (602) 417-9200

Receipt

No: 1971145

Transaction #: 2035016	
Date of Transaction: 08/05/2009	
CUSTOMER:	DAN WARE PO BOX 1200 APACHE JUNCTION, AZ 85217-1200 US

LINE #	QTY	DESCRIPTION	REMARKS	UNIT PRICE	TOTAL
1	1.00	LOCATABLE MINERALS / MINING CLAIMS-NOT NEW-UNADJUD, ONE AUTH NO. ONLY / MINING CLAIM MONEY RECEIVED CASES: AMC362705/\$840.00	MAINT 2010	- n/a -	840.00
TOTAL:					\$840.00

PAYMENT INFORMATION			
1	AMOUNT:	840.00	POSTMARKED: 07/29/2009
	TYPE:	CHECK	RECEIVED: 08/03/2009
	CHECK NO:	1229	
	NAME:	SUPERSTITION MOUNTAIN TREASURE HUNTERS INC PO BOX 1200 APACHE JUNCTION AZ 85217-1200 US	

REMARKS

This receipt was generated by the automated BLM Collections and Billing System and is a paper representation of a portion of the official electronic record contained therein.

Action Code Update

Serial-No: AMC362399

Status: ACTIVE

Bottom of Screen

	Del?	Date (mm/dd/yyyy)	Code	Action Taken	Action Remark	Receipt Nr
<input checked="" type="radio"/> 1	<input type="checkbox"/> x	07/15/2004	403	LOCATION DATE		
<input type="radio"/> 2	<input type="checkbox"/> x	08/31/2004	395	RECORDATION NOTICE RECD	\$25.00;1	942778
<input type="radio"/> 3	<input type="checkbox"/> x	08/31/2009	483	SMALL MINER CERT FILED	2010	
<input type="radio"/> 4	<input type="checkbox"/> x	08/31/2009	480	EVID OF ASSMT FILED	2009	1991999
<input type="radio"/> 5	<input type="checkbox"/> x	08/03/2009	682	MAINTENANCE FEE/\$140	2010	1971145
<input type="radio"/> 6	<input type="checkbox"/> x	12/23/2008	480	EVID OF ASSMT FILED	2008	1844681
<input type="radio"/> 7	<input type="checkbox"/> x	08/21/2008	483	SMALL MINER CERT FILED	2009	
<input type="radio"/> 8	<input type="checkbox"/> x	11/05/2007	480	EVID OF ASSMT FILED	2007	1597491
<input type="radio"/> 9	<input type="checkbox"/> x	08/30/2007	483	SMALL MINER CERT FILED	2008	
<input type="radio"/> 10	<input type="checkbox"/> x	08/25/2006	480	EVID OF ASSMT FILED	2006	1344032
<input type="radio"/> 11	<input type="checkbox"/> x	08/22/2006	483	SMALL MINER CERT FILED	2007	
<input type="radio"/> 12	<input type="checkbox"/> x	08/31/2005	483	SMALL MINER CERT FILED	2006	
<input type="radio"/> 13	<input type="checkbox"/> x	08/31/2005	480	EVID OF ASSMT FILED	2005	1143161
<input type="radio"/> 14	<input type="checkbox"/> x	02/17/2005	669	LAND STATUS CHECKED		
<input type="radio"/> 15	<input type="checkbox"/> x	12/30/2004	480	EVID OF ASSMT FILED	2004	1007532
<input type="radio"/> 16	<input type="checkbox"/> x	08/31/2004	501	ACCT ADV IN LEAD FILE	AMC362393;	
<input type="radio"/> 17	<input type="checkbox"/> x	08/31/2004	483	SMALL MINER CERT FILED	2005	
<input type="radio"/> 18	<input type="checkbox"/> x	08/31/2004	484	LOCATION YEAR / MAINTENANCE FEE	2004	942778
<input type="radio"/> 19	<input type="checkbox"/> x	08/04/2004	404	COUNTY RECORDATION	20041500629 /A/;	

Actions: 19

Provide me with new occurrences

Please SAVE&CONTINUE Between DELETES and NEW/CHANGE Lines

Save & Continue

Save & Exit

Cancel

Lookup

Serial-No: AMC362399

Top of Screen

AMC 362401
 AMC 362442
 AMC 362705
 AMC 364399

MAINTENANCE FEE PAYMENT

Claimant Name: DAN WARE
 Address: P.O. BOX 1200
 City: APACHE JCT. State: AZ Zip: 85217
 Telephone: 480-726-7489
 E-mail address: _____
 Signature: Dan Ware

RECEIVED
 BLM AZ STATE OFFICE
 2008 AUG 19 A 10: 22
 PHOENIX, ARIZONA
 BLM
 Date
 Stamp

Check here if this is a change of address.

LINE NO.	AMC NUMBER	CLAIM/SITE NAME	COUNTY RECORDER DATA (If available)	TWP	RNG	SEC
1	362705	DESERT ROSE 1	2006-0510015	25	6W	19/20
2	362445	SOARING EAGLE 2		12N	2W	12/13
3	362401	MIDGET		9N	10E	5/6/7
4	362442	B & B	2003-015410	9N	10E	7/8/18
5	362444	RIO SECO	2006-058036	52	15E	5/8/9
6	364399	STANTON ADCKER 1	FEET# 3835835	9N	4W	18
7						
8						
9						
10						

List additional claims on Form MCF114.

Bureau of Land Management
 Arizona State Office
www.az.blm.gov

No. of Claims: 6 x \$125 = 750.00
 Check No: 6551 Init. SPH
 Receipt No.: 1764998
 For BLM Use Only

This form is available from the Arizona Department of Mines and Mineral Resources and may be reproduced.

Form: MCF112
 Revised July 2005

RE 9/8/08
 ENTERED IN COMPUTER

United States Department of the Interior
Bureau of Land Management
 BUSINESS & SUPPORT SVCS DIV
 ONE N CENTRAL AVE SUITE 800
 PHOENIX, AZ 85004 -4427
 Phone: (602) 417-9200

Receipt

No:

1764998

Transaction #: 1822594	
Date of Transaction: 08/19/2008	
CUSTOMER:	DAN WARE PO BOX 1200 APACHE JUNCTION, AZ 85217

LINE #	QTY	DESCRIPTION	REMARKS	UNIT PRICE	TOTAL
1	1.00	LOCATABLE MINERALS / MINING CLAIMS-NOT NEW-UNADJUD, ONE AUTH NO. ONLY / MINING CLAIM MONEY RECEIVED (455) CASES: AMC362705/\$750.00	MAINT 2009	- n/a -	750.00
TOTAL:					\$750.00

PAYMENT INFORMATION				
1	AMOUNT:	\$750.00	POSTMARKED:	N/A
	TYPE:	CHECK	RECEIVED:	08/19/2008
	CHECK NO:	6551		
	NAME:	WARE, DAN PO BOX 1200 APACHE JUNCTION AZ 85217		

REMARKS

This receipt was generated by the automated BLM Collections and Billing System and is a paper representation of a portion of the official electronic record contained therein.

AMC 362401
 AMC 362442
 AMC 362444
 AMC 364399
 AMC 362705

MAINTENANCE FEE PAYMENT

Claimant Name: Dan Ware
 Address: P.O. 1200
 City: Apache Junction State: AZ Zip: 85217
 Telephone: 480-720-7489
 E-mail address: _____
 Signature: Dan Ware

RECEIVED
 BLM, AZ STATE OFFICE
 2006 AUG 30 A 9:45
 PHOENIX, ARIZONA
 BLM
 Date
 Stamp

Check here if this is a change of address.

LINE NO.	AMC NUMBER	CLAIM/SITE NAME	COUNTY RECORDER DATA (If available)	TWP	RNG	SEC
1	362401	M & M		9N	10E	5,6&7
2	362442	B & B		9N	10E	7,8&18
3	362444	R10 SECO		5S	15E	8&9
4	362445	SOARING EAGLE 2		12N	2W	12&13
5	364399	STANTON ROCKER 1		9N	4W	18
6	362705	DESERT ROSE 1		2S	6E	
7						
8						
9						
10						

List additional claims on Form MCF114.

No. of Claims: 6 x \$125 = 750⁰⁰
 Check No: 6490 Init. SAB/8
 Receipt No.: 1349147
 For BLM Use Only

Bureau of Land Management
 Arizona State Office
www.az.blm.gov

Form: MCF112
 Revised July 2005

This form is available from the Arizona Department of Mines and Mineral Resources and may be reproduced.

RE 9/14/06

United States Department of the Interior
 Bureau of Land Management
 BUSINESS & SUPPORT SVCS DIV
 ONE N CENTRAL AVE
 PHOENIX, AZ 85004 -2203
 Phone: (602) 417-9200

Receipt

No:

1349147

Transaction #: 1394465	
Date of Transaction: 08/31/2006	
CUSTOMER:	DAN WARE PO BOX 1200 APACHE JUNCTION, AZ 85217

LINE #	QTY	DESCRIPTION	REMARKS	UNIT PRICE	TOTAL
1	1.00	LOCATABLE MINERALS / MINING CLAIMS-NOT NEW-UNADJUD, ONE AUTH NO. ONLY / MINING CLAIM MONEY RECEIVED (455) CASES: AMC362401/\$750.00	MAINT 2007 (6)	- n/a -	750.00
TOTAL:					\$750.00

PAYMENT INFORMATION					
1	AMOUNT:	\$750.00	POSTMARKED:	08/26/2006	
	TYPE:	CHECK	RECEIVED:	08/30/2006	
	CHECK NO:	6490			
	NAME:	WARE, DAN R PO BOX 1200 APACHE JUNCTION AZ 85217			

REMARKS

This receipt was generated by the automated BLM Collections and Billing System and is a paper representation of a portion of the official electronic record contained therein.

AMC 362401
 362442
 362444
 362705
 364399

MAINTENANCE FEE PAYMENT

Claimant Name: JOSEPH R GRIEGER
 Address: 7222 E. JASMINE ST
 City: MESA State: AZ Zip: 85207
 Telephone: 480-832-6964
 E-mail address: _____
 Signature: Joseph R Grieger

Check here if this is a change of address.

RECEIVED
 B.L.M. AZ STATE OFFICE
 PHOENIX, ARIZONA
 2005 AUG 22 A 10:06
 BLM
 Date
 Stamp

LINE NO.	AMC NUMBER	CLAIM/SITE NAME	COUNTY RECORDER DATA (If available)	TWP	RNG	SEC
1	362401	MIDGET ^{YAM}	GILA	9N	10E	7,566
2	362442	B & B	GILA	9N	10E	7618
3	362444	RIO SECO	PINAL	5S	15E	5,869
4	362445	A.J. ^{Soaring Eagle} _{MINTOS}	YAVAPAI	12N	2W	12613
5	362705	DESERT ROSE 1	MARICOPA	2S	6W67W	166
6	364399	STANTON ROCKEN 1	YAVAPAI	9N	4W	18
7						
8						
9						
10						

List additional claims on Form MCF114.

No. of Claims: 6 x \$125 = 750
 Check No: CC Init. JMG
 Receipt No.: 1133634
 For BLM Use Only

Bureau of Land Management
 Arizona State Office
www.az.blm.gov

Form: MCF112
 Revised July 2005

This form is available from the Arizona Department of Mines and Mineral Resources and may be reproduced.

ENTERED INTO COMPUTER
 8/29/05 LB

United States Department of the Interior
Bureau of Land Management
 BUSINESS & SUPPORT SVCS DIV
 222 N CENTRAL AVE
 PHOENIX, AZ 85004 -2203
 Phone: (602) 417-9200

Receipt	
No:	1133634

Transaction #: 1172717
 Date of Transaction: 08/22/2005

ENTERED INTO COMPUTER

8/29/05 ps

CUSTOMER:	JOESPH R GRIEGER 7222 E JASMINE ST MESA, AZ 85207
-----------	---

LINE #	QTY	DESCRIPTION	REMARKS	UNIT PRICE	TOTAL
1	1.00	LOCATABLE MINERALS / MINING CLAIMS-NOT NEW-UNADJUD, ONE AUTH NO. ONLY / MINING CLAIM MONEY RECEIVED (455) CASES: AMC362401/\$750.00	MAINT 2006/6	- n/a -	750.00
TOTAL:					\$750.00

PAYMENT INFORMATION

NOTE: Items will appear on credit card statement as "Bureau of Land Management".

1	AMOUNT:	\$750.00	POSTMARKED:	N/A
	TYPE:	CREDIT CARD	RECEIVED:	08/22/2005
	NAME:	GRIEGER, JOESPH R 7222 E JASMINE ST MESA AZ 85207		
	CARD NO:	XXXXXXXXXXXX1009	AUTH CODE:	163524
	NAME ON CARD:	GRIEGER/JOSEPH R		
	EXPIRES:	07/31/2006		
	SIGNATURE:			

REMARKS

This receipt was generated by the automated BLM Collections and Billing System and is a paper representation of a portion of the official electronic record contained therein.

United States Department of the Interior
Bureau of Land Management
 BUSINESS & SUPPORT SVCS DIV
 222 N CENTRAL AVE
 PHOENIX, AZ 85004 -2203
 Phone: (602) 417-9200

Receipt	
No:	1133699

Transaction #: 1172784
Date of Transaction: 08/22/2005
CUSTOMER: SUPERSTITION MTN TREASURE HU 940 W APACHE TRAIL APACHE JUNCTION, AZ 85220

LINE #	QTY	DESCRIPTION	REMARKS	UNIT PRICE	TOTAL
1	1.00	LOCATABLE MINERALS / MINING CLAIMS-NOT NEW-UNADJUD, ONE AUTH NO. ONLY / MINING CLAIM MONEY RECEIVED (455) CASES: AMC364399/\$5.00	AMEND/1	- n/a -	5.00
2	3.00	IAC PRODUCTS / COPIES/PLOTTERS / COMPUTER PRINTED/GENERATED / COMPUTER GEN. REPORT-\$.13		0.13	0.39
TOTAL:					\$5.39

PAYMENT INFORMATION			
1	AMOUNT:	\$5.39	POSTMARKED: N/A
	TYPE:	DDA	RECEIVED: 08/22/2005
	DDA NO:	9604	
	BALANCE:	\$54.26	
	NAME:	- unknown -	

REMARKS

This receipt was generated by the automated BLM Collections and Billing System and is a paper representation of a portion of the official electronic record contained therein.

ENTERED BY COMPUTER
 RE 11/29/05

NOTICE!!

These documents have been scanned!

Do not place un-scanned documents beneath this notice!

Do not remove this notice from this file!

GPO Jacket No. 560-102
Print Order 61540
Rise Business Services, LLC
Job=AZ15 6/26/2019



Box Number= AZ15131



Claim Begin-End: AMC364399-AMC364399

5 Miscellaneous



AZ15131-12

AMC364221-AMC364399

**NO
DOCUMENTS
FOUND**

NO DOCUMENTS FOUND
NO DOCUMENTS FOUND

NOTICE!!

These documents have been scanned!

Do not place un-scanned documents beneath this notice!

Do not remove this notice from this file!

GPO Jacket No. 560-102
Print Order 61540
Rise Business Services, LLC
Job=AZ15 6/26/2019



Box Number= AZ15131



Claim Begin-End: AMC364399-AMC364399

6 Location Notices-Amendments and Supporting Documents



AZ15131-12

AMC364221-AMC364399

MINING CLAIM STATUS REPORT

STATUS:

MTP CHECKED BY TR
GEO CHECKED BY TR
PRE-ADJ BY _____
FINAL ADJ BY TR

LEAD SERIAL NO. AMC 364399 THROUGH AMC _____

# _____	LODE	LOCATION FEE @ \$25 =	\$ <u>25</u>
# _____	PLACER	SERVICE FEE @ \$10 =	\$ <u>10</u>
# <u>1</u>	ASSOCIATION PL	MAINTENANCE FEE @ \$100 =	\$ <u>100</u>
# _____	MILL SITE	OVERAGE	\$ _____
# _____	TUNNEL SITE	SHORTAGE	\$ _____
		OTHER FEES	\$ _____
		TOTAL	\$ <u>135</u>

OVER-THE-COUNTER MAIL TIMELY FILED: YES NO

LEGAL DESCRIPTION: T 9N R 4W SEC 18
T _____ R _____ SEC _____
T _____ R _____ SEC _____
T _____ R _____ SEC _____

JURISDICTION: BLM FOREST SERVICE

WILDERNESS AREA: NO YES

SPLIT ESTATE: SX PX SRHA OTHER N/A
PROPER NOTICE FILED IF LOCATED ON SRHA LANDS: YES NO N/A

RECONVEYED MINERALS ON BLM LANDS REQUIRE OPENING ORDERS FROM 1944 TO 1993. OPEN TO ENTRY ON: _____

SUBJECT TO PL 359: YES NO

STATUS; VOID PARTIALLY VOID PRIVATE MINERALS
WITHDRAWN LANDS OTHER

CLAIMANT ACKNOWLEDGES THAT PORTIONS OF THE FOLLOWING CLAIM(S)/SITE(S): _____
MAY BE VOID OR VOIDABLE. Signature of Claimant: _____

COMMENTS: _____

When recorded, mail 

Name: Dan Ware

Address: P.O. Box 1200

City/State/Zip: Apache Junction, AZ. 85217

LOCATION NOTICE FOR PLACER MINING CLAIM

• TYPE OF NOTICE: Location Amendment Relocation

• The name and address of the Locator is:

Name: Joseph R. Grieger

Address: 7222 E. Jasmine St.

City/State/Zip Code: Mesa, AZ. 85207

The name of the Claim is: Stanton Rocker I **AMC 364399**

• The date of the location is: 01/04/2005

• The Claim is 2640 feet long and 660 feet wide. The distance from the location monument to each end of the claim is 660 feet in a eastern direction and 2640 feet in a southern direction.

• The general course of the claim is 660' from NW 1/4 Lot 3 corner Section 18 to the NE corner, 2640' to the SE corner, 660' to the SW corner. 2640' to the NW corner. to the NE Corner. NW 1/4, SW 1/4

• The location of the claim is in Section 18, Township 9N, Range R 4W lot 3, & 4, Base and Meridian, Gila and Salt River Mining District, Yavapai County, State of Arizona.

• If amending or relocation, the previous claim name was Stanton Rocker I, recorded in Docket (Book) _____ page(s) _____, Mining District, _____ County, State of Arizona.

• The location of the claim with reference to a natural object or permanent monument is: Metal stakes with capped PVC pipe.

Dated: 8/15, 2005

Signature: Joseph R. Grieger

Address: 7222 E Jasmine St.

City/State/Zip: Mesa, AZ. 85207

RECORDED
11/29/05

PHOENIX, ARIZONA

RECEIVED
B.L.M. AZ STATE OFFICE
2005 AUG 22 A 10:44



CLAIM MAP

Lode () Placer (x)

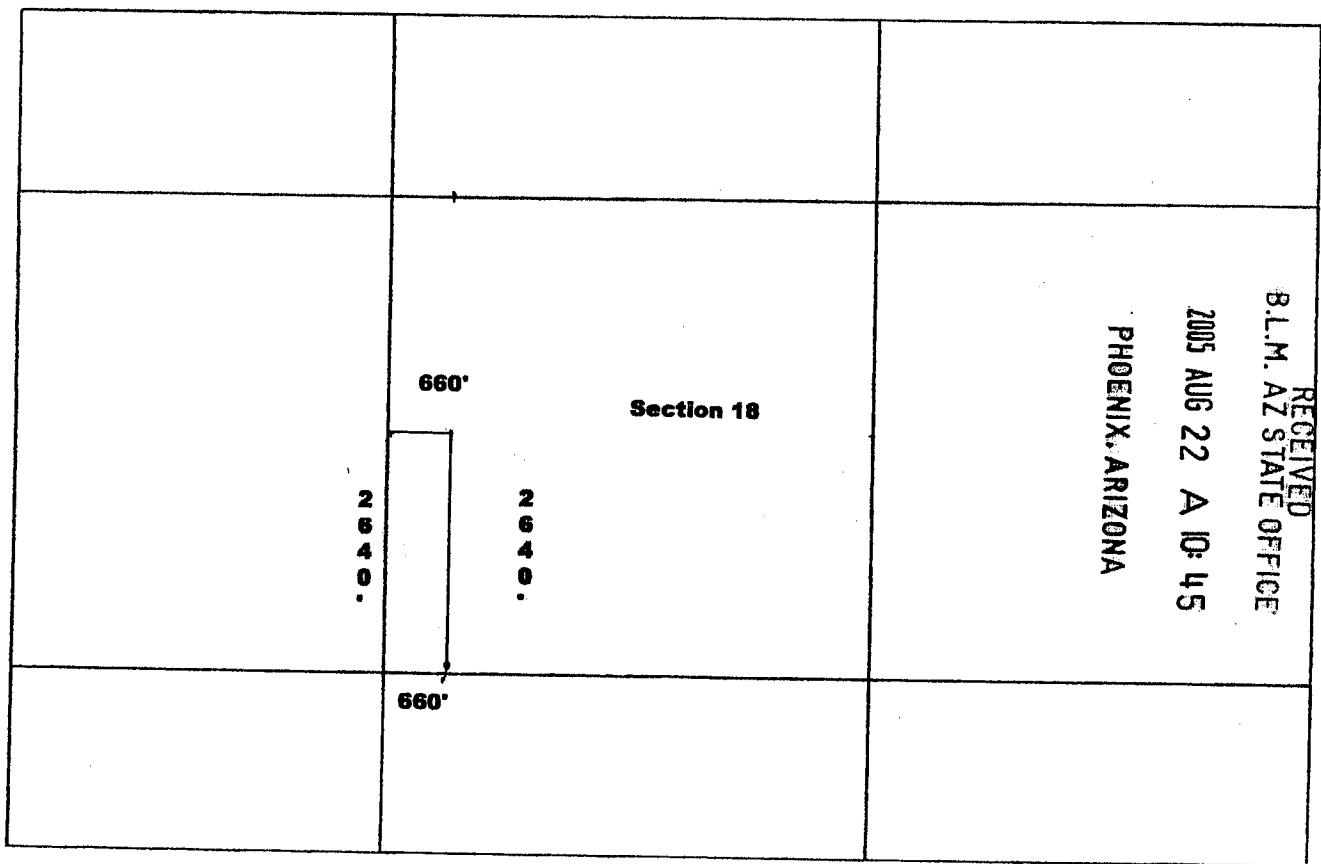

Scale: 1" = 2077'

1. The above map depicts the Stanton Rocker I mining claim, which is located in Section (s) 18, Township 9 N, Range 4 W, Gila and Salt River Base and Meridian, Yavapai County, Arizona.

2. The type of corner and location monuments used are as follows: Metal stakes with capped PVC pipe.

3. The bearings and distances in degrees and feet between claim corners are as depicted on the map.

RE 11/29/05

When recorded, mail to:

Name: Dan Ware

Address: P.O. Box 1200

City/State/Zip: Apache Junction, AZ. 85217

LOCATION NOTICE FOR PLACER MINING CLAIM

• TYPE OF NOTICE: Location Amendment Relocation

• The name and address of the Locator is:

Name: Joseph R. Grieger

Address: 7222 E. Jasmine St.

City/State/Zip Code: Mesa, AZ.85207

The name of the Claim is: Stanton Rocker I

AMC 364399

• The date of the location is: 01/04/2005

• The Claim is 2640 feet long and 660 feet wide. The distance from the location monument to each end of the claim is 660 feet in a eastern direction and 2640 feet in a southern direction.

• The general course of the claim is 660' from NW 1/4 Lot 3 corner Section 18 to the NE corner, 2640' to the SE corner, 660' to the SW corner. 2640' to the NW corner. to the NE Corner. NW 1/4, SW 1/4

• The location of the claim is in Section 18, Township 9N, Range R 4W lot 3, & 4, Base and Meridian, Gila and Salt River Mining District, Yavapai County, State of Arizona.

• If amending or relocation, the previous claim name was Stanton Rocker I, recorded in Docket (Book) _____ page(s) _____, Mining District, _____ County, State of Arizona.

• The location of the claim with reference to a natural object or permanent monument is: Metal stakes with capped PVC pipe.

Dated: 8/15, 2005

Signature. Joseph R. Grieger

Address: 7222 E Jasmine St.

City/State/Zip: Mesa, AZ. 85207

RECEIVED
B.L.M. AZ STATE OFFICE
2005 AUG 22 A 10:44
PHOENIX, ARIZONA

ENTERED INTO COMPUTER
RE

Handwritten initials: tmc

CLAIM MAP

Lode () Placer (x)

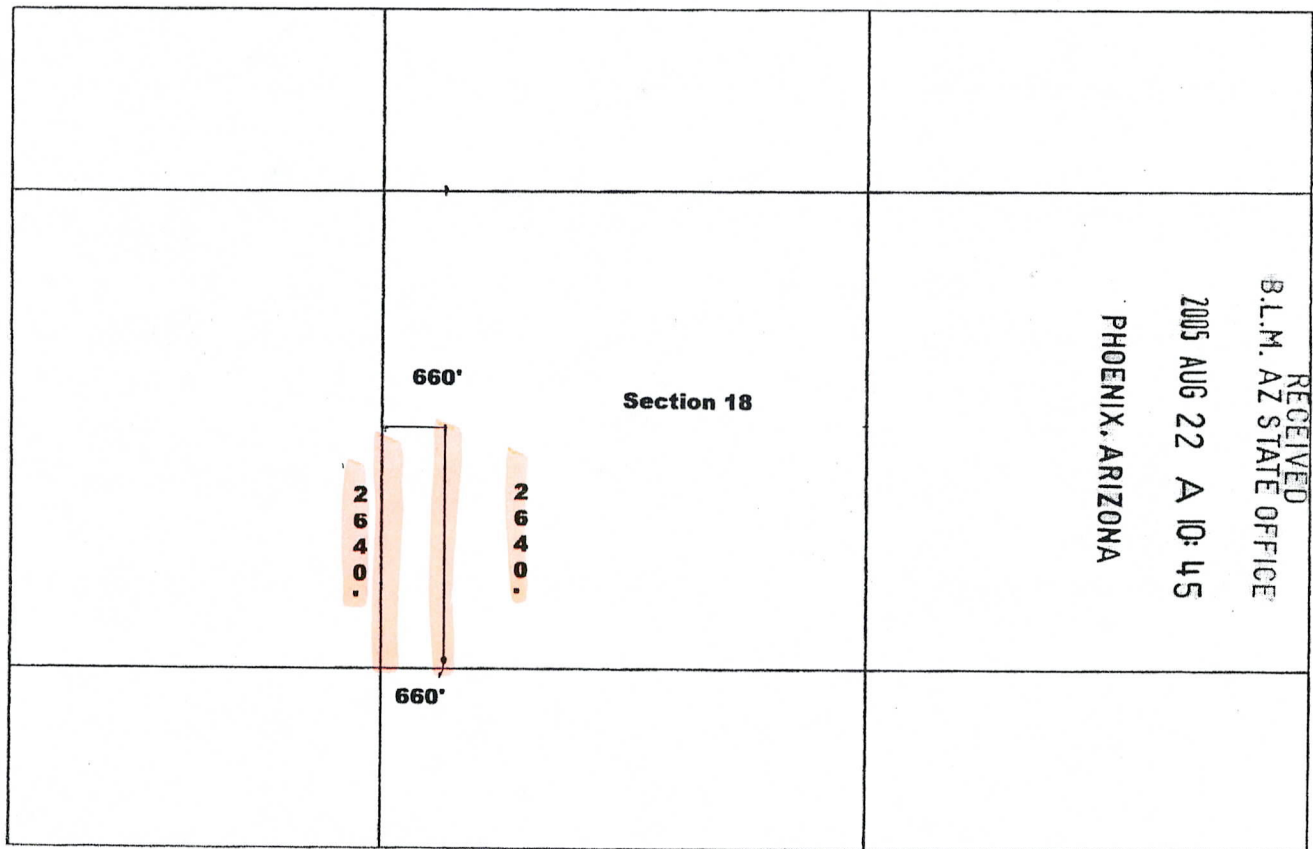

Scale : 1" = 2077'

1. The above map depicts the Stanton Rocker I mining claim, which is located in Section (s) 18, Township 9 N, Range 4 W, Gila and Salt River Base and Meridian, Yavapai County, Arizona.

2. The type of corner and location monuments used are as follows: Metal stakes with capped PVC pipe.

3. The bearings and distances in degrees and feet between claim corners are as depicted on the map.

When recorded, mail to:

Name: Dan Ware

Address: P.O. Box 1200

City/State/Zip: Apache Junction, AZ. 85217

LOCATION NOTICE FOR PLACER MINING CLAIM

• TYPE OF NOTICE: Location Amendment Relocation

• The name and address of the Locator is:

Name: Joseph R. Grieger

Address: 7222 E. Jasmine St.

City/State/Zip Code: Mesa, AZ.85207

The name of the Claim is: Stanton Rocker 1

• The date of the location is: 01/04/2005

• The Claim is 660 feet long and 5280 feet wide. The distance from the location monument to each end of the claim is 660 feet in a eastern direction and 5280 feet in a southern direction.

• The general course of the claim is from the 660' from NW corner Section 18 to the NE corner, 5280' to the SE corner, 660' to the SW corner. 5280' to the NW corner.

NW 1/4, SW 1/4

• The location of the claim is in Section 18, Township 9N, Range 4W, LOT 1, 2, 3 & 4, Base and Meridian, Gila and Salt River Mining District, Yavapai County, State of Arizona.

• If amending or relocation, the previous claim name was _____, recorded in Docket (Book) _____ page(s) _____, Mining District, _____ County, State of Arizona.

• The location of the claim with reference to a natural object or permanent monument is: NE corner of section 18 and SW corner of section 7

Dated: 2/16, 2005

Signature: Joseph R. Grieger

Address: 7222 E Jasmine St.

City/State/Zip: Mesa, AZ. 85207

PHOENIX, ARIZONA

2005 FEB 16 A 10: 32

RECEIVED B.L.M. AZ STATE OFFICE

AM 364399

CLAIM MAP

Lode () Placer (x)

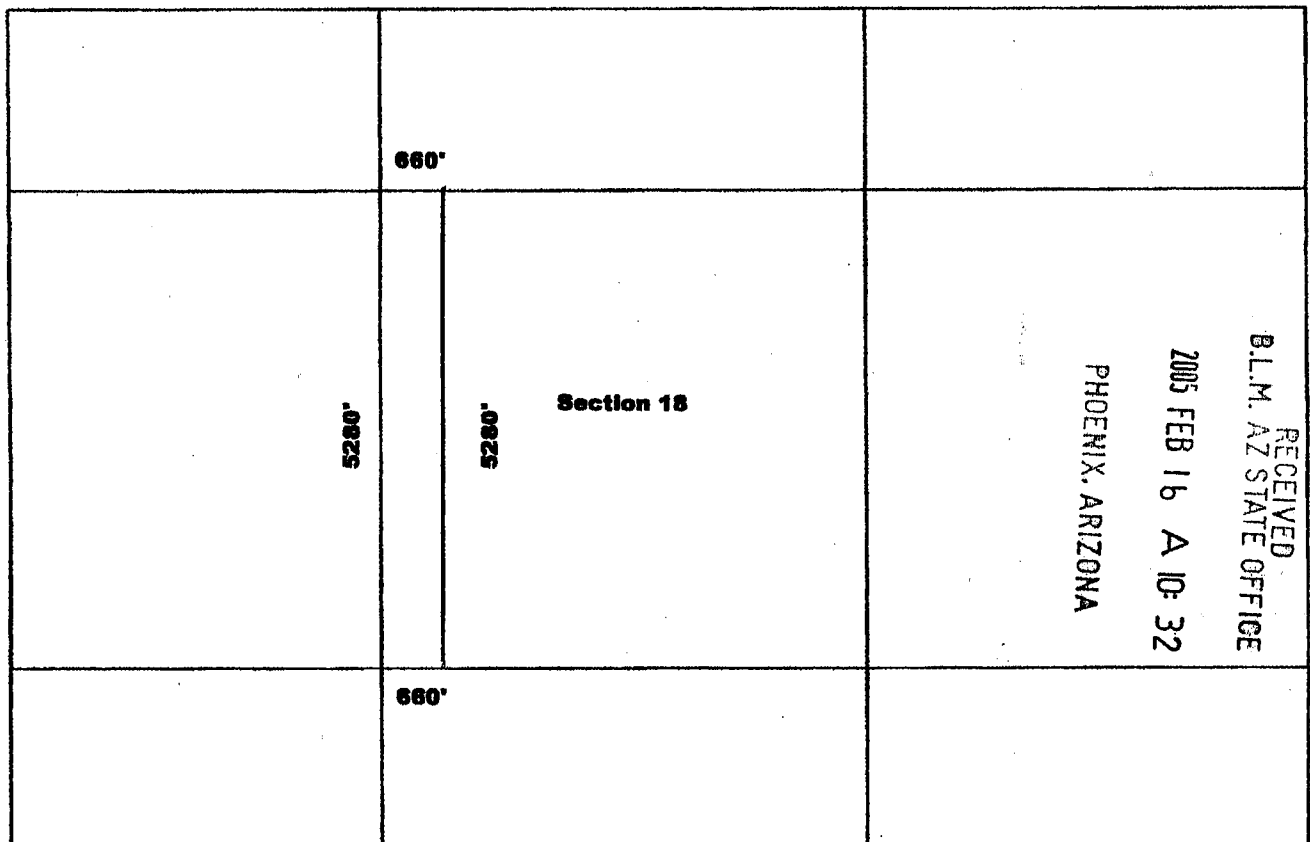

AMB 364399

Scale: 1" = 2077'

1. The above map depicts the Stanton 90418 mining claim, which is located in Section (s) 18, Township 9 N, Range 4 W, Gila and Salt River Base and Meridian, Yavapai County, Arizona.

2. The type of corner and location monuments used are as follows: Metal stakes with capped PVC pipe.

3. The bearings and distances in degrees and feet between claim corners are as depicted on the map.

++

STANTON ROCKER I MINING ASSOCIATION ARTICLES OF ASSOCIATION

WITNESSETH:

The following persons (herein referred to as Associates) have associated on
This _____ day of _____, 200__, for the purpose of staking association
Placer claims in Gila & Salt River Mining District of
Yavapai County, Arizona.

Joe Grieger, 7222 E. Jasmine St., Mesa, AZ 85207

Signature

Ted Montague, P.O. Box 4705, Apache Jct., AZ

Signature

Leo DeRocher 5087 Crested Saguaro LN., Gold Canyon, AZ

Signature

Dan Ware, 370 N. Winchester Rd., Apache Jct., AZ

Signature

PHOENIX, ARIZONA

2005 FEB 16 A 10: 32

RECEIVED
B.L.M. AZ STATE OFFICE

All of the Associates are citizens of the United States and over the age of eighteen (18). The Associates agree to the following terms and conditions:

- 1) They will meet in January of each year to review these articles and make whatever changes are deemed necessary.

None of the Associates can be removed by any means other than a majority vote of the Associates or by death or incapacitation, except by their own request.

The Associates agree to work the property in a workmanlike manner and in full compliance with the laws and regulations of The United States of America.

Each Associate agrees if he/she should die, become unable to act as an Associate or wish to relinquish his/her interest, that interest shall become equal property of the remaining Associate members.

FILED 2005 FEB 16

CLAIM NAME Stanton Rocker 1

ADDITIONAL OWNERS:

Name: Joseph R. Grieger
Address: 7222 E. Jasmine St.
City/State/Zip Mesa, AZ. 85207-2929
Tele. Number 480-832-6964

Name: Ted Montague
Address: 4826 N. Valley Drive
City/State/Zip Apache Junction, AZ. 85220
Tele. Number 480-982-1790

Name: Leonard A. Derocher
Address: 5087 Crested Saguaro LN
City/State/Zip Gold Canyon, AZ 85218
Tele. Number 480-288-1235

Name: Dan Ware
Address: P. O. Box 1200
City/State/Zip Apache Junction, AZ. 85217
Tele. Number 480-288-0965

Name: _____
Address: _____
City/State/Zip _____
Tele. Number _____

Name: _____
Address: _____
City/State/Zip _____
Tele. Number _____

Name: _____
Address: _____
City/State/Zip _____
Tele. Number _____

PHOENIX, ARIZONA

2005 FEB 16 A 10: 32

RECEIVED
B.L.M. AZ STATE OFFICE

APR 30 4 3 44

RUN TIME: 10:19 AM

Adm State: AZ

UNITED STATES DEPARTMENT OF INTERIOR
BUREAU OF LAND MANAGEMENT
GEOGRAPHIC REPORT WITH LAND
Sorted by Meridian Township Range

RUN DATE: 02/16/2005
Page 1 of 2

Serial Number: AZA 014745
Total Case Acres: 2,884.150

<u>Casetype</u>	<u>Case Disp</u>	14	0090N	0040W	<u>Sect</u>	<u>Sur Typ</u>	<u>Sur Num</u>	<u>Suff</u>	<u>Subdivision</u>	<u>Act Pend</u>
311111	CLOSED				018	ALIQ LOTS			E2; 1-4;	

Serial Number: AZA 024191
Total Case Acres: 1.000

<u>Casetype</u>	<u>Case Disp</u>	14	0090N	0040W	<u>Sect</u>	<u>Sur Typ</u>	<u>Sur Num</u>	<u>Suff</u>	<u>Subdivision</u>	<u>Act Pend</u>
380913	CLOSED				018	FF		1	PORTION OF;	

Serial Number: AZA 026666
Total Case Acres: 1.000

<u>Casetype</u>	<u>Case Disp</u>	14	0090N	0040W	<u>Sect</u>	<u>Sur Typ</u>	<u>Sur Num</u>	<u>Suff</u>	<u>Subdivision</u>	<u>Act Pend</u>
380913	CLOSED				018	FF		1	PART;	

Serial Number: AZA 027138
Total Case Acres: 0.250

<u>Casetype</u>	<u>Case Disp</u>	14	0090N	0040W	<u>Sect</u>	<u>Sur Typ</u>	<u>Sur Num</u>	<u>Suff</u>	<u>Subdivision</u>	<u>Act Pend</u>
380913	CLOSED				018	FF		1	PART OF N2N2SE;	

Serial Number: AZA 027733
Total Case Acres: 1.000

<u>Casetype</u>	<u>Case Disp</u>	14	0090N	0040W	<u>Sect</u>	<u>Sur Typ</u>	<u>Sur Num</u>	<u>Suff</u>	<u>Subdivision</u>	<u>Act Pend</u>
380913	CLOSED				018	FF		1	PART;	

RUN TIME: 10:19 AM

Adm State: AZ

**UNITED STATES DEPARTMENT OF INTERIOR
BUREAU OF LAND MANAGEMENT
GEOGRAPHIC REPORT WITH LAND
Sorted by Meridian Township Range**

**RUN DATE: 02/16/2005
Page 2 of 2**

Input Parameters for Geographic Report with Land

System Id = CR

Admin State = AZ

Geo State =

Casetype begins with

Case Disp Txt =

Mer Twp Rng =

Mtrs = 14 0090N 0040W 018

Commodity =

Pending Org =

Section =

Total Rows Returned: 6

